

UHF CONNECTORS

UHF SPECIFICATIONS

MATERIALS:

Body : Brass
 Contacts: Nickel plated brass
 Dielectric: Delrin

ELECTRICAL:

Nominal Impedance: Non constant
 Frequency Range: 0-500MHz
 Voltage Rating: 500VAC
 Withstanding Voltage: 1000V RMS
 Insulation Resistance: 5000M Ω min.



UHF CHASSIS JACK

21-238-0 Bulk
 21-238-1 Package



UHF CHASSIS JACK

21-239-0 Bulk
 21-239-1 Package

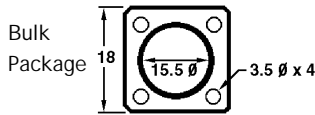

UHF STANDARD PLUG



For RG8/u - use reducing adapters below for RG58 or 59

21-259-0 Bulk
 21-259-1 Package



UHF REDUCING ADAPTER

21-260-0 RG58/u
 21-261-0 RG59/u
 Use -2 for Display Package



UHF TRIPLE JACK

21-264-0 Bulk
 21-264-1 Package



UHF 'T'

21-265-0 Bulk
 21-265-1 Package



MALE UHF JOINER

21-266-0 Bulk
 21-266-1 Package



UHF BULKHEAD MOUNT

50mm long with mtg. nuts
 21-267-0 Bulk
 21-267-1 Package



FEMALE UHF JOINER

21-268-0 Bulk
 21-268-1 Package



UHF RIGHT ANGLE

21-269-0 Bulk
 21-269-1 Package

BNC CONNECTORS

BNC SPECIFICATIONS

MATERIALS:

Body: Nickel plated brass
 Contacts: Gold plated brass or phosphor bronze
 Dielectric: Delrin

ELECTRICAL:

Nominal Impedance: 50 Ω
 Frequency range: 0-4 GHz
 Voltage rating: 500VAC
 Withstanding voltage: 1500V RMS
 Insulation resistance: 5000M Ω min.

ISOLATED CHASSIS JACK

21-337-0 Bulk
 21-337-1 Package

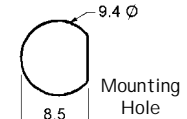

CHASSIS JACK



21-338-0 Bulk
 21-338-1 Package

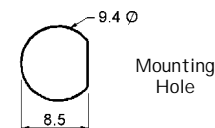

CRIMP PLUG

New 21-346-0 RG6/U
 21-348-0 RG58/u
 21-349-0 RG59/u
 Use -1 for Display Package



CRIMP JACK

21-350-0 Bulk
 21-350-1 Package
 for RG58/u



BNC TERMINATORS

21-351-0 50 Ω
 21-352-0 75 Ω
 Use -1 for Display Package



TWIST-ON PLUG

21-353-0 RG58/u
 21-354-0 RG59/u
 Use -1 for Display Package



STANDARD PLUG (Clamp Type)

21-358-0 RG58/u
 21-359-0 RG59/u
 Use -1 for Display Package



TRIPLE JACK

21-364-0 Bulk
 21-364-1 Package

'T' CONNECTOR



21-365-0 Bulk
21-365-1 Package

MALE JOINER



21-366-0 Bulk
21-366-1 Package

PANEL MOUNT JACK



21-367-0 Bulk
21-367-1 Package

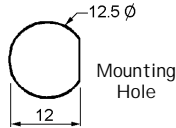

FEMALE JOINER



21-368-0 Bulk
21-368-1 Package

RIGHT ANGLE ELBOW



21-369-0 Bulk
21-369-1 Package

RUBBER CABLE BOOTS

These rubber boots for BNC crimp connectors provide a professional molded look to coaxial cables.



21-398-0 RG58/u
21-399-0 RG59/u
Use -6 for Display Package

N CONNECTORS

SPECIFICATIONS

MATERIALS:

Body: Nickel plated brass
Contacts: Gold plated brass or phosphor bronze
Dielectric: Delrin

ELECTRICAL:

Nominal Impedance: 50Ω
Frequency range: 0-4 GHz
Voltage rating: 500VAC
Withstanding voltage: 1500V RMS
Insulation resistance: 5000MΩ min.

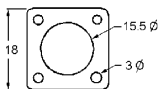

CHASSIS JACK

Mounting Holes 21-439-0 Bulk
21-439-1 Package

CRIMP/SOLDER PLUG (RG58/u)



21-450-0 Bulk
21-450-1 Package

Centre-pin soldered

N CONNECTORS cont'd

STANDARD PLUG (RG8/u)



21-457-0 Bulk
21-457-1 Package

STANDARD PLUG (RG58/u)



21-458-0 Bulk
21-458-1 Package

'T' CONNECTOR



21-465-0 Bulk
21-465-1 Package

MALE JOINER



21-466-0 Bulk
21-466-1 Package

FEMALE JOINER



21-468-0 Bulk
21-468-1 Package

RIGHT ANGLE ELBOW



21-469-0 Bulk
21-469-1 Package

Special Order Products

If you have a requirement for items not shown in this Catalog, please contact Mode or your local Distributor and we would be pleased to find an economical source.



Mode Electronics is proud to be ISO 9003 Certified.

MINI UHF CONNECTORS

MINI UHF SPECIFICATIONS

MATERIALS:

Body : Brass
 Contacts: Nickel plated brass
 Dielectric: Delrin

ELECTRICAL:

Nominal Impedance: Non constant
 Frequency Range: 0-2GHz
 Voltage Rating: 500VAC
 Withstanding Voltage: 1000V RMS
 Insulation Resistance: 5000M Ω min.

CHASSIS JACK



21-538-0 Bulk
 21-538-1 Package

CRIMP PLUG RG58/u



21-548-0 Bulk
 21-548-1 Package

'T' CONNECTOR



21-564-0 Bulk
 21-564-1 Package

'T' CONNECTOR



21-565-0 Bulk
 21-565-1 Package

MALE JOINER



21-566-0 Bulk
 21-566-1 Package

FEMALE JOINER



21-568-0 Bulk
 21-568-1 Package

RIGHT ANGLE ELBOW



21-569-0 Bulk
 21-569-1 Package

TNC CONNECTORS

TNC SPECIFICATIONS

MATERIALS:

Body: Nickel plated brass
 Contacts: Gold plated brass or phosphor bronze
 Dielectric: Delrin

ELECTRICAL:

Nominal Impedance: 50 Ω
 Frequency range: 0-4 GHz
 Voltage rating: 500VAC
 Withstanding voltage: 1500V RMS
 Insulation resistance: 5000M Ω min.

CRIMP CHASSIS JACK (RG58/u)



21-736-0 Bulk
 21-736-1 Package

CRIMP PLUG (RG58/u)



21-748-0 Bulk
 21-748-1 Package

CRIMP PLUG (RG59/u)



21-749-0 Bulk
 21-749-1 Package

STANDARD PLUG (RG58/u)



21-758-0 Bulk
 21-758-1 Package

FEMALE JOINER



21-768-0 Bulk
 21-768-1 Package

RIGHT ANGLE ELBOW



21-769-0 Bulk
 21-769-1 Package

SMA CONNECTORS

CRIMP PLUG FOR RG174/U



21-847-0 Bulk
 21-847-1 Package

CRIMP PLUG FOR RG58/U



21-848-0 Bulk
 21-848-1 Package

FEMALE JOINER



21-868-0 Bulk
 21-868-1 Package



24-100-0 Bulk
24-100-2 Pkg (2)

Metal body RCA plug. Maximum cable dia. 7.5mm



24-104-0 Bulk
24-104-2 Pkg (2)

Metal plug with strain relief. Maximum cable dia. 4.5mm



24-101-0 Black
24-102-0 Red
24-109-4 Pkg (4)

Colored plastic body RCA plugs. Max. cable dia. 4.5mm.



24-111-0 Black
24-112-0 Red
24-113-4 Pkg (4)

Colored plastic with strain relief. Max. cable dia. 4.5mm



24-114-0 Bulk
24-114-2 Pkg (2)

Black plastic right angle RCA plug. Max. cable dia. 5.1mm



24-116-0 Bulk
24-116-2 Pkg (2)

Crimp RCA plug for RG59/u



24-118-0 Bulk
24-118-1 Pkg

Precision machined RCA plug for RG58/u



24-120-0 Bulk
24-120-1 Pkg

Gold plated plug with spring strain relief. Cable dia 5.5mm



24-121-0 Black
24-122-0 Red
24-123-2 Pkg (2)

Color coded gold plated plugs. Max. cable dia. 5.0mm



24-124-0 Black
24-125-0 Red
24-126-2 Pkg (2)

Color coded gold plated plugs. Max cable dia. 6.0mm



24-150-0 Bulk
24-150-2 Pkg (2)

Metal body RCA jack. Max. cable dia. 7.5mm



24-151-0 Black
24-152-0 Red
24-159-2 Pkg (2)

Colored plastic RCA jacks. Max. cable dia. 5.0mm



24-161-0 Black
24-162-0 Red
24-163-2 Pkg (2)

Gold plated color coded jacks. Max. cable dia. 5.0mm



24-171-0 Bulk
24-171-6 Pkg (6)

Phenolic insulated RCA chassis jack. Mtg. holes 18mm C/C



24-172-0 Bulk
24-172-2 Pkg (2)

Phenolic insulated dual RCA jacks.

22 x 56mm. 48mm
C/C mounting holes.



24-180-0 Bulk
24-180-2 Pkg (2)

Chassis mount RCA jack.
6mm mounting hole.



24-181-0 Bulk
24-181-2 Pkg (2)

Gold plated chassis RCA jack.
6mm mounting hole.

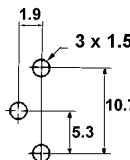

24-191-0 Bulk
24-191-2 Pkg (2)

PC mount RCA jack

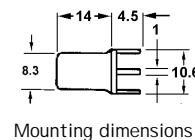

24-192-0 Bulk
24-192-2 Pkg (2)

PC mount RCA jack

Mounting dimensions

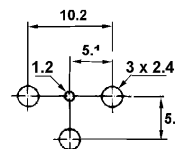

24-195-0 Bulk
24-195-2 Pkg (2)

Right angle PC
mount RCA jack

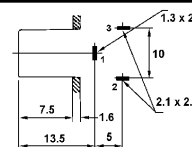

24-196-0 Bulk
24-196-2 Pkg (2)

Right angle PC
mount RCA jack

Mode Electronics is proud to
be ISO 9003 Certified.



2.5mm PLUGS



2.5mm mono plug. Maximum cable dia. 6mm



Mono plug 26mm long x 10mm dia. Cable dia. 5.5mm



Mono plug 48mm x 10mm dia. Cable diameter 4mm

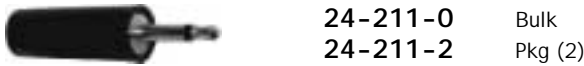

Mono plug 23 x 8mm dia. Cable diameter 4mm



Stereo plug 22mm x 8.5mm dia. Cable diameter 4mm



Stereo plug 48mm x 10mm dia. Cable diameter 4mm

2.5mm JACKS



Inline mono jack Black color Cable dia. 6mm

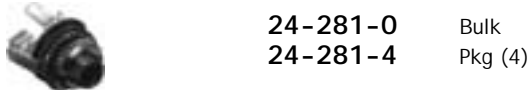

Mono chassis jack (closed circuit). 4mm mtg. hole

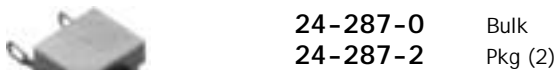
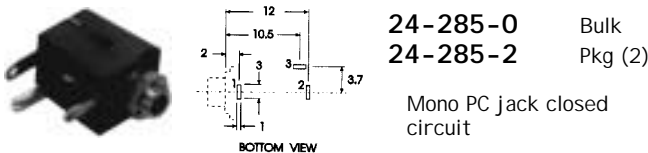

Mono chassis jack closed circuit. 4mm mtg. hole



Stereo chassis jack. 4mm mtg. hole

3.5mm PLUGS



Metal mono plug 25 x 9mm dia. Cable dia. 6.5mm



Mono plug 25 x 10mm diameter. Cable dia. 5mm



Red plastic mono plug. 25 x 10mm dia. Cable dia. 5mm



Mono plug 52 x 10mm dia. Cable dia. 4mm



Metal mono plug 53 x 9mm dia. Cable dia. 4.5mm

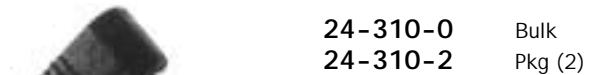

3.5mm mono right angle plug



Black mono plug 23 x 8mm dia. Cable dia. 4mm

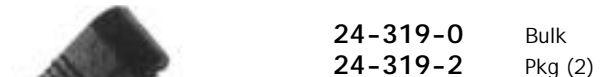

3.5mm stereo right angle plug



Metal stereo plug. 26mm x 9mm dia. Cable dia. 6.5mm



Black plastic stereo plug. 27 x 10mm dia. Cable 6mm dia.



Metal stereo plug. 52 x 9mm dia. Cable dia. 4.5mm



Black plastic stereo plug. 52 x 10mm dia. Cable dia. 4mm

1/4" JACKS



24-650-0	Bulk
24-650-1	Pkg

Mono inline jack. Cable dia. 6mm



24-652-0	Bulk
24-652-1	Pkg

Metal mono inline jack. Cable dia. 9mm



24-653-0	Bulk
24-653-1	Pkg

Metal mono inline jack. Cable diameter 6mm



24-670-0	Bulk
24-670-1	Pkg

Stereo inline jack. Cable dia. 6.0mm



24-671-0	Bulk
24-671-1	Pkg

Stereo inline jack. Cable dia. 7.5mm



24-672-0	Bulk
24-672-1	Pkg

Metal stereo inline jack. Cable diameter 9mm



24-673-0	Bulk
24-673-1	Pkg

Metal stereo inline jack. Cable dia. 6mm

1/4" CHASSIS JACKS



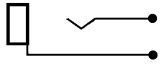

Mono chassis jack. 9mm mounting hole

	24-680-0	Bulk
	24-680-1	Pkg





Mono chassis jack with switch. 9mm mounting hole

	24-681-0	Bulk
	24-681-1	Pkg



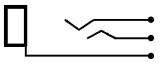

Stereo chassis jack. 9mm mounting hole

	24-690-0	Bulk
	24-690-1	Pkg

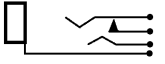

Stereo chassis jack. 9mm mounting hole

	24-691-0	Bulk
	24-691-1	Pkg

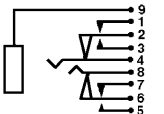

Stereo chassis jack with 2 SPDT switches. 9mm mtg. hole

	24-697-0	Bulk
	24-697-1	Pkg

DIN CONNECTORS

INLINE DIN JACKS



25-130-0	3-position
25-140-0	4-position
25-150-0	5-position
25-160-0	6-position
25-180-0	8-position

Use -1 for Display Package

INLINE DIN PLUGS



25-230-0	3-position
25-240-0	4-position
25-250-0	5-position
25-260-0	6-position
25-280-0	8-position

Use -1 for Display Package

CHASSIS MOUNT DIN JACKS

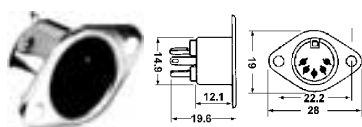

25-330-0	3-position
25-340-0	4-position
25-350-0	5-position
25-360-0	6-position
25-380-0	8-position

Use -1 for Display Package

SHIELDED PC MOUNT DIN JACK

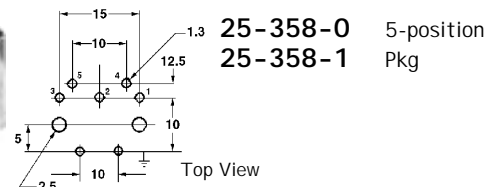

PC MOUNT DIN JACK

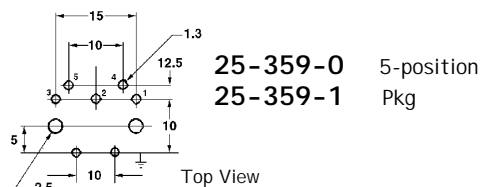

METAL INLINE DIN PLUG



25-450-0	5-pos.
25-450-1	Pkg

STANDARD 'DIN' PIN LAYOUTS

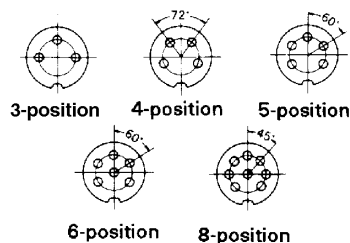

MINI DIN CONNECTORS

INLINE JACKS



26-140-0 4-position
26-160-0 6-position
26-180-0 8-position
Use -1 for Display Pkg.

INLINE PLUGS



26-240-0 4-position
26-250-0 5-position
26-260-0 6-position
26-280-0 8-position
Use -1 for Display Pkg.

PC MOUNT MINI DIN JACKS

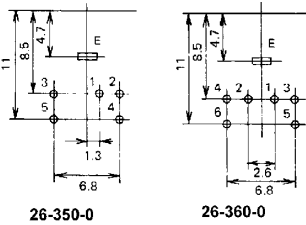

26-350-0 5-position
26-360-0 6-position
Use -1 for Display Pkg.

MICROPHONE CONNECTORS



25-513-0 3-pos jack
25-513-1 Pkg



25-515-0 5-pos jack
25-515-1 Pkg



25-523-0 3-pos plug
25-523-1 Pkg



25-525-0 5-pos plug
25-525-1 Pkg



25-533-0 3-pos. jack
25-533-1 Pkg



25-535-0 5-pos. jack
25-535-1 Pkg



25-543-0 3-pos. plug
25-543-1 Pkg



25-545-0 5-pos. plug
25-545-1 Pkg

INLINE PLUGS



25-722-0 2-position
25-723-0 3-position
25-724-0 4-position
25-725-0 5-position
25-726-0 6-position
25-728-0 8-position
Use -1 for Display Package

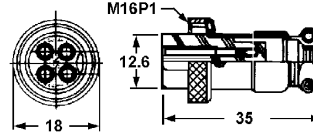

CHASSIS JACKS



25-732-0 2-position
25-733-0 3-position
25-734-0 4-position
25-735-0 5-position
25-736-0 6-position
25-738-0 8-position
Use -1 for Display Package

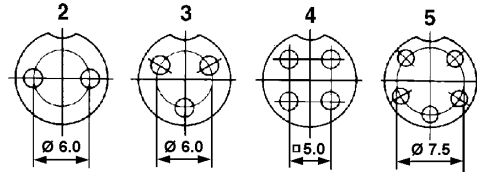
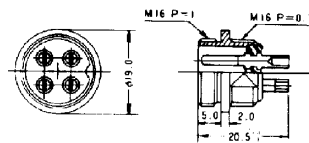

Pin Layout

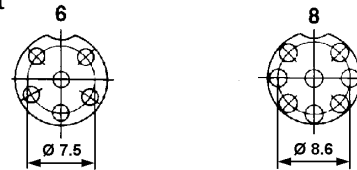

PRECISION MINIATURE CONNECTOR

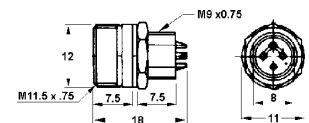
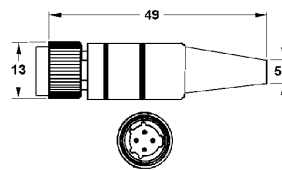

This miniature precision six contact connector features gold plated contacts, threaded locking ring and precision fit and finish.

25-746-0 6-position plug
25-746-1 Display Package
25-756-0 6-position jack
25-756-1 Display Package

D-SUB SPECIFICATIONS

MATERIALS

Shell: Yellow chromate or tin plated steel
 Contacts: Male - Brass (gold plated over nickel)
 Female - Gold plated phosphor bronze
 Insulator: PBT & glass-fibre reinforced UL94V-0

ELECTRICAL

Current rating: 3 amps
 Working voltage: 125V RMS
 Dielectric strength: 1000 volts for 1 minute
 Insulation resistance: 1000MΩ @ 500VDC
 Temperature range: -55 to +105 degrees C

SOLDER D-SUB CONNECTORS (MALE)



- 30-110-0** 9-position
 - 30-111-0** 15-position
 - 30-112-0** 25-position
 - 30-113-0** 37-position
 - 30-114-0** 50-position
- Use -1 for Display Package*

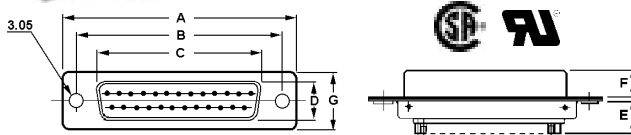

Size	A	B	C	D	E	F	G
9-pin	30.80	25.00	16.92	8.30	8.0	1.2	12.5
15-pin	39.20	33.30	25.25	8.30	8.0	1.2	12.5
25-pin	53.10	47.10	38.96	8.30	8.0	1.2	12.5
37-pin	69.40	63.50	55.42	8.30	8.0	1.2	12.5
50-pin	67.00	61.00	52.81	11.30	8.0	1.2	15.3

SOLDER D-SUB CONNECTORS (FEMALE)



- 30-120-0** 9-position
 - 30-121-0** 15-position
 - 30-122-0** 25-position
 - 30-123-0** 37-position
 - 30-124-0** 50-position
- Use -1 for Display Package*

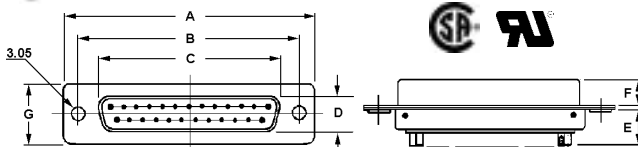

Size	A	B	C	D	E	F	G
9-pin	30.80	25.00	16.30	7.90	8.0	1.2	12.5
15-pin	39.20	33.30	24.60	7.90	8.0	1.2	12.5
25-pin	53.10	47.10	38.30	7.90	8.0	1.2	12.5
37-pin	69.40	63.50	54.80	7.90	8.0	1.2	12.5
50-pin	67.00	61.00	52.20	10.9	8.0	1.2	15.3

MACHINED CONTACT D-SUB (MALE)



- 30-140-0** 9-position
 - 30-141-0** 15-position
 - 30-142-0** 25-position
 - 30-143-0** 37-position
 - 30-144-0** 50-position
- Use -1 for Display Package*

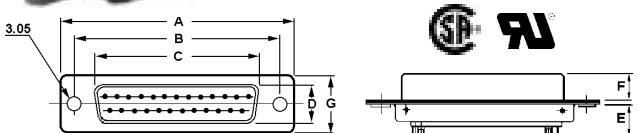

Size	A	B	C	D	E	F	G
9-pin	30.80	25.00	16.92	8.30	8.0	1.2	12.5
15-pin	39.20	33.30	25.25	8.30	8.0	1.2	12.5
25-pin	53.10	47.10	38.96	8.30	8.0	1.2	12.5
37-pin	69.40	63.50	55.42	8.30	8.0	1.2	12.5
50-pin	67.00	61.00	52.81	11.30	8.0	1.2	15.3

MACHINED CONTACT D-SUB (FEMALE)



- 30-150-0** 9-position
 - 30-151-0** 15-position
 - 30-152-0** 25-position
 - 30-153-0** 37-position
 - 30-154-0** 50-position
- Use -1 for Display Package*

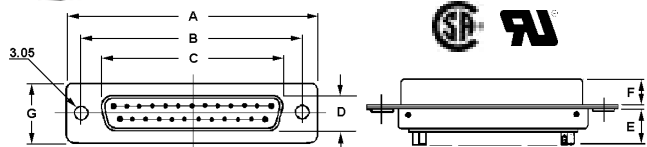

Size	A	B	C	D	E	F	G
9-pin	30.80	25.00	16.30	7.90	8.0	1.2	12.5
15-pin	39.20	33.30	24.60	7.90	8.0	1.2	12.5
25-pin	53.10	47.10	38.30	7.90	8.0	1.2	12.5
37-pin	69.40	63.50	54.80	7.90	8.0	1.2	12.5
50-pin	67.00	61.00	52.20	10.9	8.0	1.2	15.3

CRIMP D-SUB CONNECTORS (MALE)



- 30-210-0** 9-position
 - 30-211-0** 15-position
 - 30-212-0** 25-position
 - 30-213-0** 37-position
 - 30-214-0** 50-position
- Display package (-1) contains connector body plus contacts*

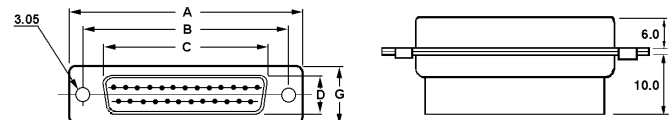

Size	A	B	C	D	G
9-pin	30.80	25.00	16.92	8.30	12.5
15-pin	39.20	33.30	25.25	8.30	12.5
25-pin	53.10	47.10	38.96	8.30	12.5
37-pin	69.40	63.50	55.42	8.30	12.5
50-pin	67.00	61.00	52.81	11.30	15.3

CRIMP D-SUB CONNECTORS (FEMALE)



- 30-220-0** 9-position
 - 30-221-0** 15-position
 - 30-222-0** 25-position
 - 30-223-0** 37-position
 - 30-224-0** 50-position
- Display package (-1) contains connector body plus contacts*

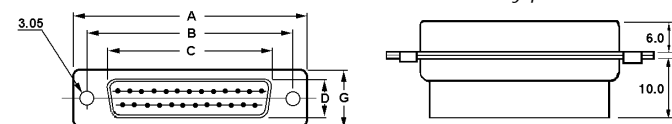

Size	A	B	C	D	G
9-pin	30.80	25.00	16.30	7.90	12.5
15-pin	39.20	33.30	24.60	7.90	12.5
25-pin	53.10	47.10	38.30	7.90	12.5
37-pin	69.40	63.50	54.80	7.90	12.5
50-pin	67.00	61.00	52.81	10.9	15.3

D-sub connectors and accessories are continued on pages 21 and 22.

Visit our Web Site at
<http://www.mode-elec.com>

CRIMP CONTACTS

Contacts for 30-21X and 30-22X series on previous page
Gold plated D-sub contacts. Available loose or on 5,000 pce. reels for machine application. Suitable for 20-24 AWG wire size.



30-226-0
30-227-0

Male contacts (loose)
Male contacts (5,000 reel)



30-228-0
30-229-0

Female contacts (loose)
Female contacts (5,000 reel)

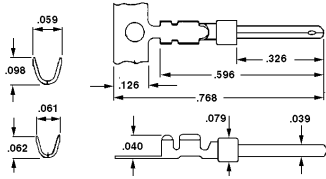

D-SUB HOODS



Grey plastic D-sub hoods complete with all hardware

30-130-0 9-position
30-131-0 15-position
30-132-0 25-position
30-133-0 37-position
30-134-0 50-position
Use -1 for Display Package

Chrome plated plastic D-sub hoods for EMI /RFI shielding



30-230-0 9-position
30-231-0 15-position
30-232-0 25-position
30-233-0 37-position
30-234-0 50-position
Use -1 for Display Package

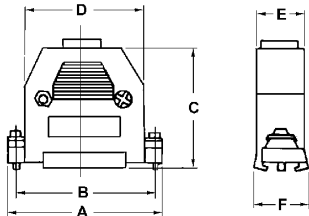

Size	A	B	C	D	E	F
9-pin	31.00	24.99	39.50	20.50	16.0	16.0
15-pin	39.00	33.32	35.50	28.00	16.0	16.0
25-pin	53.20	47.04	41.00	37.00	18.5	18.5
37-pin	72.00	63.50	42.00	51.00	23.0	23.0
50-pin	69.10	61.11	44.00	54.10	23.0	23.0

FEMALE LOCK POSTS



Locking hardware c/w nuts & washers (set of two)

30-023-0 Bulk only

MALE LOCK SCREWS



Locking screws c/w clip-on captivators (set of two)

30-028-0 Bulk only

PRINTED CIRCUIT MOUNT D-SUBS (MALE)



30-310-0 9-position
30-311-0 15-position
30-312-0 25-position
30-313-0 37-position
30-314-0 50-position
Use -1 for Display Package

PRINTED CIRCUIT MOUNT D-SUBS (FEMALE)



30-320-0 9-position
30-321-0 15-position
30-322-0 25-position
30-323-0 37-position
30-324-0 50-position
Use -1 for Display Package

Male dimensions

Size	A	B	C	D	E
9-pin	16.92	25.00	30.80	8.30	12.5
15-pin	25.25	33.30	39.20	8.30	12.5
25-pin	38.96	47.10	53.10	8.30	12.5
37-pin	55.42	63.50	69.40	8.30	12.5
50-pin	52.81	61.00	67.00	11.3	15.3

Female dimensions

Size	A	B	C	D	E
9-pin	16.30	25.00	30.80	7.90	12.5
15-pin	24.60	33.30	39.20	7.90	12.5
25-pin	38.30	47.10	53.10	7.90	12.5
37-pin	54.80	63.50	69.40	7.90	12.5
50-pin	52.20	61.00	67.00	10.9	15.3

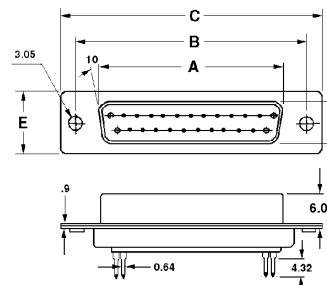

HIGH DENSITY SOLDER D-SUBS (MALE)



30-810-0 15-position
30-811-0 26-position
30-812-0 44-position
Use -1 for Display Package

Size	A	B	C
15-pos	16.92	25.00	30.8
26-pos	25.25	33.30	39.2
44-pos	38.96	47.10	53.1

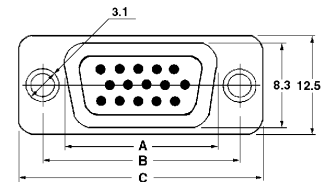

HIGH DENSITY SOLDER D-SUBS (FEMALE)



30-820-0 15-position
30-821-0 26-position
30-822-0 44-position
Use -1 for Display Package

Size	A	B	C
15-pos	16.30	25.00	30.8
26-pos	24.60	33.30	39.2
44-pos	38.30	47.10	53.1

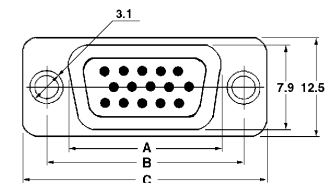

MALE LOCK POSTS

Knurled lock posts -use with hoods (set 2)



30-030-0 Bulk only

RIGHT ANGLE P.C. MOUNT D-SUB (MALE)

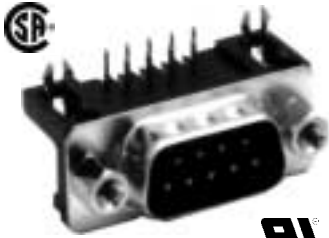

.318"/8.1mm footprint

- 30-410-0 9-position
 - 30-411-0 15-position
 - 30-412-0 25-position
 - 30-413-0 37-position
- Use -1 for Display Package

Size	A	B	C
9-pos	16.92	25.00	30.8
15-pos	25.25	33.30	39.2
25-pos	38.96	47.10	53.1
37-pos	55.42	63.50	69.4

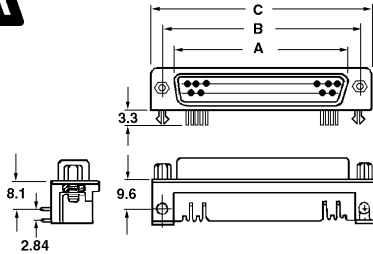

HIGH DENSITY R/A P.C. MOUNT D-SUBS (FEMALE)



- 30-860-0 15-position
 - 30-861-0 26-position
- Use -1 for Display Package

Size	A	B	C	D
15-pos	16.30	12.5	25.00	30.8
26-pos	24.60	12.5	33.30	39.2

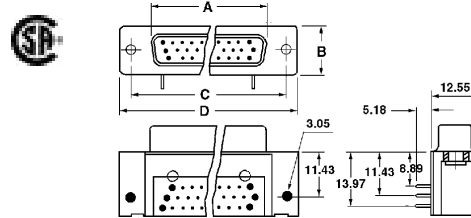

RIGHT ANGLE P.C. MOUNT D-SUB (FEMALE)

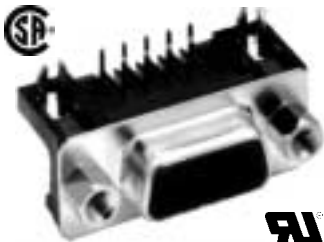

.318"/8.1mm footprint

- 30-420-0 9-position
 - 30-421-0 15-position
 - 30-422-0 25-position
 - 30-423-0 37-position
- Use -1 for Display Package

Size	A	B	C
9-pos	16.30	25.00	30.8
15-pos	24.60	33.30	39.2
25-pos	38.30	47.10	53.1
37-pos	54.80	63.50	69.4

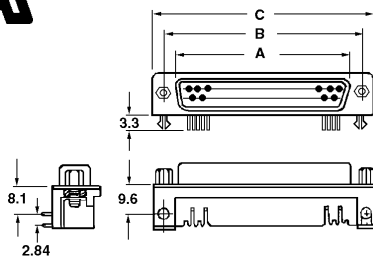

CENTRONICS CONNECTORS

CABLE PLUGS



- 30-902-0 36-position
 - 30-903-0 50-position
- Use -1 for Display Package

RIBBON CABLE PLUGS



- 30-942-0 36-position
 - 30-943-0 50-position
- Use -1 for Display Package

RIBBON CABLE RECEPTACLES



- 30-946-0 36-position
 - 30-947-0 50-position
- Use -1 for Display Package

RIBBON CABLE D-SUBS (MALE)



- 30-710-0 9-position
 - 30-711-0 15-position
 - 30-712-0 25-position
 - 30-713-0 37-position
- Use -1 for Display Package

Size	A	B	C
9-pos	16.92	25.00	30.8
15-pos	25.25	33.30	39.2
25-pos	38.96	47.10	53.1
37-pos	55.42	63.50	69.4

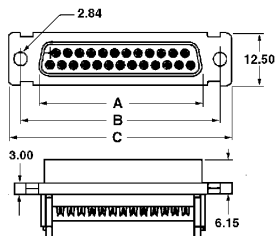

RIBBON CABLE D-SUBS (FEMALE)



- 30-720-0 9-position
 - 30-721-0 15-position
 - 30-722-0 25-position
 - 30-723-0 37-position
- Use -1 for Display Package

Size	A	B	C
9-pos	16.30	25.00	30.8
15-pos	24.60	33.30	39.2
25-pos	38.30	47.10	53.1
37-pos	54.80	63.50	69.4

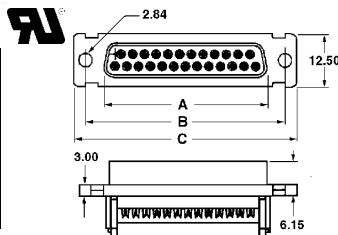

RIBBON CABLE



- 08-1410-100 10-conductor
- 08-1414-100 14-conductor
- 08-1416-100 16-conductor
- 08-1420-100 20-conductor
- 08-1425-100 25-conductor
- 08-1426-100 26-conductor
- 08-1434-100 34-conductor
- 08-1440-100 40-conductor
- 08-1450-100 50-conductor

Grey jacket 28 AWG stranded .050" ribbon cable. Available in 100' spools only. Rated 300V 105 degrees C. UL and CSA listed.



Mode Electronics is proud to be ISO 9003 Certified.



2/18 LINE CORDS (6' LONG)



3-WIRE CHASSIS RECEPTACLE

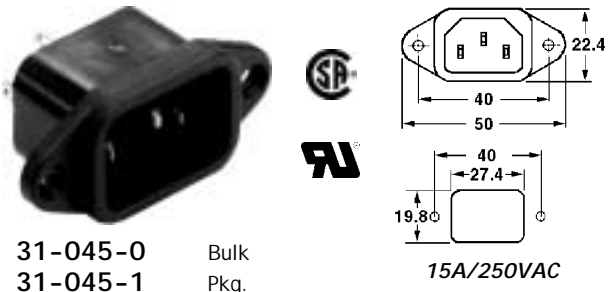

3/18 SVT LINE CORD (6' LONG)



AC OUTLET STRIP

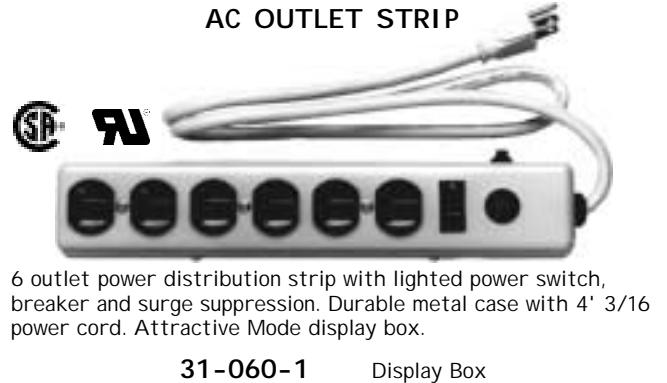

EQUIPMENT POWER CORD (6' LONG)

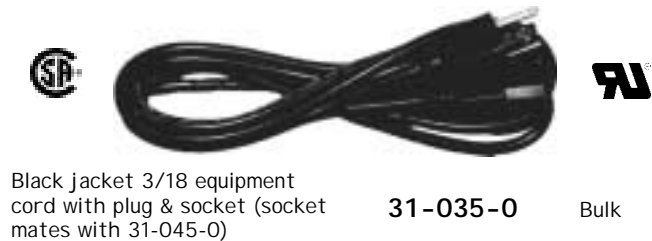

AC OUTLET STRIP

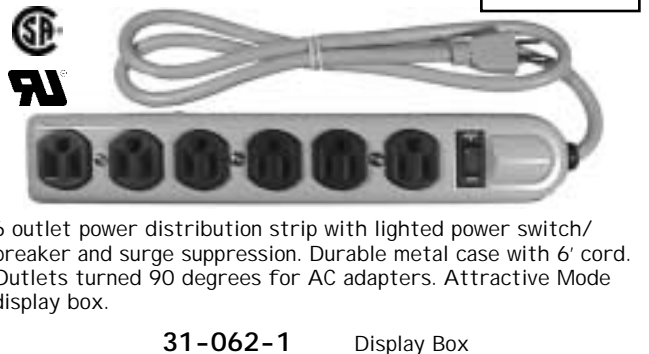

2-WIRE CHASSIS RECEPTACLE

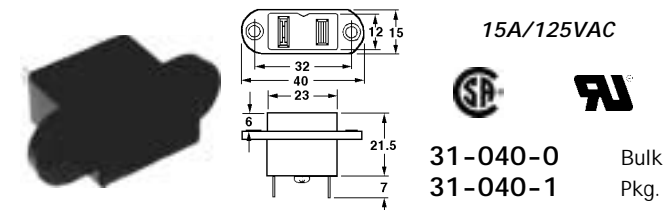

2-WIRE SNAP-IN RECEPTACLE

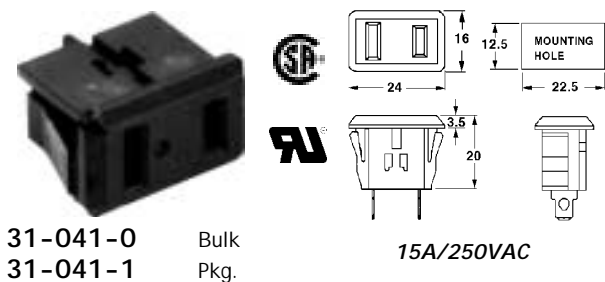

AC OUTLET STRIP

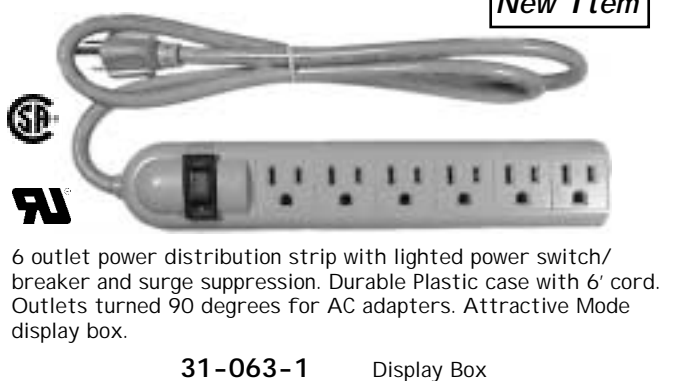

3-WIRE CHASSIS RECEPTACLE

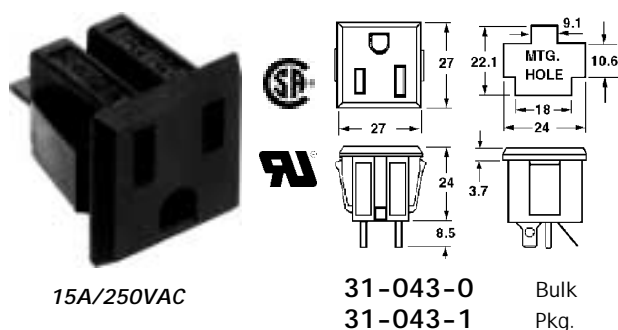

FEMALE AUTO POWER JACK



More Auto plugs on next page

AUTO POWER PLUG c/w LED



Fuseable auto power plug with LED indicator.

- 31-085-0 Bulk
- 31-085-1 Pkg.

FUSED AUTO POWER PLUG



Auto cigarette lighter plug with fuse holder.

- 31-088-0 Bulk
- 31-088-1 Pkg.

STANDARD AUTO PLUG



Standard auto cigarette lighter plug.

- 31-089-0 Bulk
- 31-089-1 Pkg.



AUTO PLUG/CORD

New Item *

- 31-097-0 * 2.5mm R/A Plug/Fuse/LED 6' Cord Bulk
- 31-097-1 * 2.5mm R/A Plug/Fuse/LED 6' Cord Pkg
- 31-099-0 2.1mm Plug 8' cord Bulk
- 31-099-1 2.1mm Plug 8' cord Pkg.

DC POWER PLUGS



- 31-101-0 1.3mm
 - 31-121-0 2.1mm
 - 31-141-0 2.5mm
- Use -2 for Display Package

9mm barrel length 4 mm cable diameter



- 31-122-0 2.1mm
 - 31-142-0 2.5mm
- Use -2 for Display Package

14mm barrel length 4 mm cable diameter



- 31-123-0 2.1mm
 - 31-143-0 2.5mm
 - 31-161-0 3.0mm
- Use -2 for Display Package

9mm barrel length 4 .3mm cable diameter



- 31-124-0 2.1mm
 - 31-144-0 2.5mm
- Use -2 for Display Package

14mm barrel length 4 .3mm cable diameter

DC POWER JACKS



- 31-132-0 2.1mm
 - 31-152-0 2.5mm
- Use -1 for Display Package

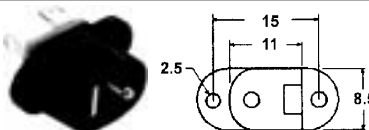

- 31-133-0 2.1mm
 - 31-153-0 2.5mm
- Use -2 for Display Package

13mm chassis mtg. hole.



- 31-134-0 2.1mm
 - 31-154-0 2.5mm
- Use -2 for Display Package

DC POWER JACKS cont'd



Compact isolated chassis mount DC power jack. 8mm mounting hole.

New Item

- 31-134M-0 2.1mm
 - 31-154M-0 2.5mm
- Use -2 for Display Package

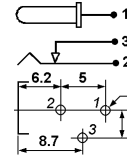

- 31-150-0 1.3mm
- Use -2 for Display Package

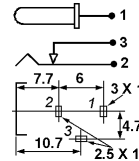

- 31-155-0 2.1mm
 - 31-155A-0* 2.1mm
 - 31-155S-0* 2.1mm
 - 31-156-0 2.5mm
 - 31-156S-0* 2.5mm
- Use -2 for Display Package

New Item

*

31-155-0 & 31-156-0 PET Material 230 deg. C
31-155A ABS Material 150 deg. C
31-155S & 31-156S Valox Material 250 deg. C

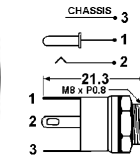

- 31-157-0 2.1mm
 - 31-158-0 2.5mm
- Use -1 for Display Package

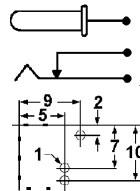

- 31-159-0 2.5mm
- Use -2 for Display Package

CHASSIS BANANA JACKS

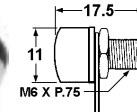

- 31-401-0 Black
- 31-402-0 Red
- 31-400-2 Pkg (2)

BINDING POSTS

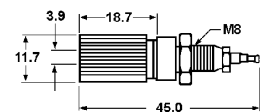

- 31-421-0 Black
- 31-422-0 Red
- 31-425-0 Green
- 31-420-2 Pkg (red & blk)

LOW PROFILE BINDING POSTS

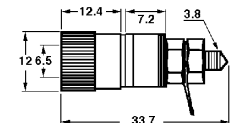

- 31-431-0 Black
- 31-432-0 Red
- 31-430-2 Pkg 1 red 1 black

BANANA PLUGS

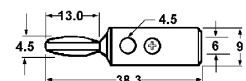

- 31-461-0 Black
- 31-462-0 Red
- 31-460-2 Pkg 1 red 1 black

.062" CONTACT CONNECTORS



Plug	Receptacle	Package	Contacts
37-002-0	37-102-0	37-202-2	2
37-003-0	37-103-0	37-203-2	3
37-004-0	37-104-0	37-204-1	4
37-005-0	37-105-0	37-205-1	5
37-006-0	37-106-0	37-206-1	6
37-009-0	37-109-0	37-209-1	9
37-012-0	37-112-0	37-212-1	12

Package contains 1 or 2 plugs, receptacles and contacts



37-910-0

Female contacts 18-24 AWG



37-900-0

Male contacts 18-24 AWG

.093" CONTACT CONNECTORS

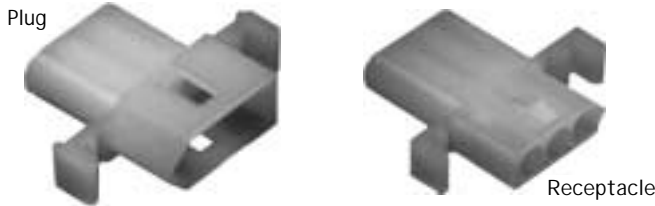

Plug	Receptacle	Package	Contacts
37-302-0	37-402-0	37-502-2	2
37-303-0	37-403-0	37-503-1	3
37-304-0	37-404-0	37-504-1	4
37-306-0	37-406-0	37-506-1	6
37-309-0	37-409-0	37-509-1	9
37-312-0	37-412-0	37-512-1	12

Package contains plug, receptacle and contacts



37-940-0

Female contacts 18-22 AWG



37-930-0

Male contacts 18-22 AWG

.100" WIRE CONNECTORS

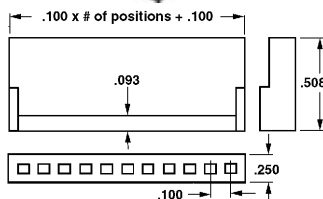

37-960-0 Bulk 22-28 AWG contacts

37-602-0	2-position
37-603-0	3-position
37-604-0	4-position
37-605-0	5-position
37-606-0	6-position
37-608-0	8-position
37-609-0	9-position



See the following page as well as the tool section starting on Page 55 for crimp tools and insertion/extraction tools for the crimp contacts shown on this page.

New Item

.100" PC HEADERS

Straight PC headers for 37-60X series. .64mm PC posts.

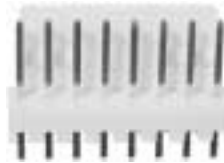

37-6202-0	2-position
37-6203-0	3-position
37-6204-0	4-position
37-6205-0	5-position
37-6206-0	6-position
37-6208-0	8-position

Right angle PC headers for 37-60X series. .64mm PC posts.

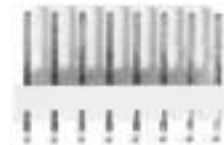

37-6302-0	2-position
37-6303-0	3-position
37-6304-0	4-position
37-6305-0	5-position
37-6306-0	6-position
37-6308-0	8-position

New Item

.156" WIRE CONNECTORS



37-702-0	2-position
37-704-0	4-position
37-706-0	6-position
37-708-0	8-position
37-710-0	10-position



37-970-0

Bulk 18-22AWG contacts

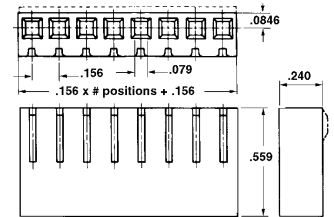

.156" PC HEADERS

Straight PC headers for 37-70X series. 1.14mm PC posts.

New Item

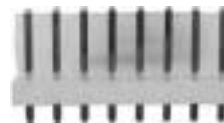

37-7202-0	2-position
37-7204-0	4-position
37-7206-0	6-position
37-7208-0	8-position
37-7210-0	10-position

New Item

Right Angle PC headers for 37-70X series. 1.14mm PC posts.

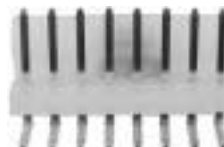

37-7302-0	2-position
37-7304-0	4-position
37-7306-0	6-position
37-7308-0	8-position
37-7310-0	10-position

New Item