

DOUBLE OUTLET FLUSH MOUNT WALL PLATE



Double wall plates. Fits standard electrical box.

- 12-232-0 Ivory 6P/4C
- 12-232W-0 White 6P/4C
- 12-234-0 Ivory 6P/6C
- 12-234W-0 White 6P/6C
- 12-236-0 Ivory 8P/8C
- 12-236W-0 White 8P/8C

Use -1 for Display Package

MODULAR TELEPHONE PLUGS

Modular telephone plugs with 15µ" gold plated contacts.



- 12-251-0 10P/10C
- 12-253-0 4P/4C
- 12-254-0 6P/4C
- 12-256-0 6P/6C
- 12-258-0 8P/8C

Use -10 for Display Package

MODULAR TELEPHONE PLUGS (for round cable)

Modular telephone plugs for round jacket cable with 15µ" gold plated contacts. R types are for stranded wire and S type is for solid wire.



- 12-254R-0 6P/4C
- 12-256R-0 6P/6C
- 12-258R-0 8P/8C
- * 12-258S-0 8P/8C

Use -10 for Display Package

PC MOUNT MODULAR JACKS

Printed circuit mount modular jacks. 15µ" gold plating.



- 12-264-0 6P/4C
- 12-266-0 6P/6C
- New** 12-288-0 8P/8C

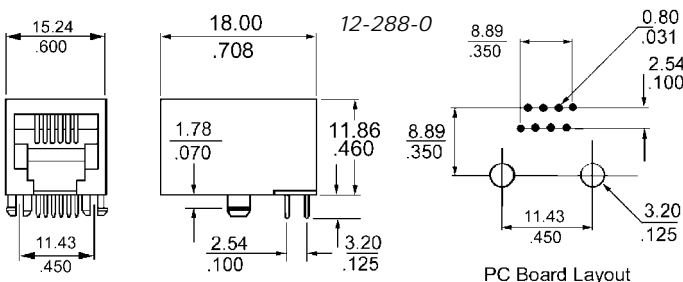
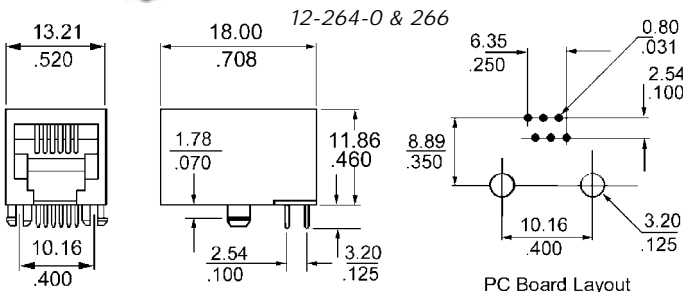

MODULAR CRIMP TOOL

Economy modular crimp tool. Cuts cable to length, strips jacket and crimps modular plug to cable. Suitable for 4P/4C and 6P/4C.



- 12-294-0 Bulk
- 12-294-1 Package

DELUXE MODULAR CRIMP TOOL

Deluxe crimp tool cuts, strips and crimps modular plugs. Features replaceable cutting blades.



- 12-306-1 6P/4C & 6C
 - 12-308-1 8P/8C
- Replacement blades available

MODULAR TELEPHONE CABLE

28AWG stranded modular telephone cable. Available in silver-satin or beige jacket color.



- 12-402-0 4-conductor 100'
- 12-403-0 Beige 4-conductor 1000'
- 12-403-0 Silver 4-conductor 1000'
- 12-602-0 6-conductor 100'
- 12-603-0 Beige 6-conductor 1000'
- 12-603-0 Silver 6-conductor 1000'
- 12-805-0 Beige 8-conductor 1000'
- 12-805-0 Silver 8-conductor 1000'

100' not on spools

The items shown in this catalog are normal stock items at Mode, but we can also source many additional products from reliable sources. If you have a requirement for a product not shown in this catalog, please contact us or your local distributor for price and delivery.

New

CATEGORY 5 PLUGS

For round jacket/solid conductor cable.



13-101-0 30µ" Gold
13-102-0 50µ" Gold
Use -5 for Display Package

CATEGORY 5 KEYSTONE JACK



This jack requires no tooling. A color coded lift-up lid is used to place and insert the wires.



13-111-0 white color
13-111BL-0 blue color
13-111GN-0 green color
13-111RD-0 red color
13-111YL-0 yellow color

Use -1 for Display Package

CATEGORY 5 KEYSTONE JACK



Standard 110 type IDC strips.



13-112-0 white color
13-112BL-0 blue color
13-112GN-0 green color
13-112RD-0 red color
13-112YL-0 yellow color

Use -1 for Display Package

JACK HOLDING FIXTURE



Inexpensive fixture to hold 13-112-0 for wire insertion.



13-112F-0 Bulk
13-112F-1 Pkg

SINGLE SURFACE MOUNT BOX



Single outlet surface mount box for 13-111-0 or 13-112-0 jack.



13-121-0 White
Use -1 for Display Package

DOUBLE SURFACE MOUNT BOX



Double outlet surface mount box for 13-111-0 or 13-112-0 jack.



13-122-0 White
Use -1 for Display Package



FLUSH MOUNT WALL PLATES

White flush mount wall plates for 13-111-0 or 13-112-0 jack.



13-131-0 for 1 jack - White
13-132-0 for 2 jacks - White
13-134-0 for 4 jacks - White
Use -1 for Display Package

INSERTS FOR SURFACE MOUNT PLATES

Blank Insert-White



13-140-0 Bulk
13-140-2 Pkg 2

ST Insert-White



13-141-0 Bulk
13-141-2 Pkg 2

BNC Insert-White



13-142-0 Bulk
13-142-1 Pkg 1

ADHESIVE LABEL SHEET



For easy marking of outlets and patch panels.

13-145-0 Bulk
13-145-2 Pkg 2

PATCH CORDS



Category 5 patch cords - available in 3', 7', 10', 14', and 25' lengths - colors - blue, yellow & grey.

13-161BL-0 3' Long Blue
13-161GY-0 3' Long Grey
13-161YL-0 3' Long Yellow
13-162BL-0 7' Long Blue
13-162GY-0 7' Long Grey
13-162YL-0 7' Long Yellow
13-163BL-0 10' Long Blue
13-163GY-0 10' Long Grey
13-163YL-0 10' Long Yellow
13-164BL-0 14' Long Blue
13-164GY-0 14' Long Grey
13-164YL-0 14' Long Yellow
13-165BL-0 25' Long Blue
13-165GY-0 25' Long Grey
13-165YL-0 25' Long Yellow

Use -1 for Display Package



CATEGORY 5 BULK CABLE

13-170GY-1000

Category 5 bulk cable. 4-pair unshielded 24AWG solid. Grey flame retardant PVC jacket. 1000' "easy-pull" box.

COLOR CODED CABLE BOOTS



Use -4 for Display Package

- 13-190BK-0** Black
- 13-190BL-0** Blue
- 13-190GR-0** Green
- 13-190GY-0** Grey
- 13-190RD-0** Red
- 13-190YL-0** Yellow

CATEGORY 5 TOOLING



13-180-0 Bulk **13-180-1** Pkg.
Adjustable impact punch tool - using one of the inserts (top of next column) this tool will insert and trim wires for the 13-112-0 keystone jack.

13-186-1 Pkg.
Adjustable impact punch tool c/w 13-183-0 insert. Attractive display Package.



13-181-0 Bulk **13-181-1** Pkg.
Non-impact punch tool - using one of the inserts (top of next column) this tool will insert and trim wires for the 13-112-0 keystone jack.

13-187-1 Pkg.
Non-impact punch tool c/w 13-183-0 insert. Attractive display package.

The Category 5 products shown on pages 6 and 7 are stocked items. We have access to many additional items such as patch panels, different styles of outlet boxes, etc. If you have a requirement for an item or items not shown on these pages, please contact us or your local Mode Distributor for price and delivery information.

Inserts for 13-180-0 and 13-181-0 punch tools.



13-182-0
For 66 type terminals- reversible punch or punch & cut



13-183-0
For 110 type terminals- reversible punch or punch & cut



13-184-0
For 66 & 110/88type terminals. Punch only

CABLE STRIP TOOL



13-185-0
Universal stripping tool for round or flat Cat 5 cable.
Use -1 for Display Package

ABOUT THIS CATALOG

Our catalog is produced using Quark Express V 4.1 on a PC with Pentium II processor. Most of the photo's are now taken on a Sony Mavica digital camera and re-worked in Adobe Photoshop V 5.0.

The catalog is printed by Hemlock Printers in Burnaby.

It is transferred to the printers digitally via an FTP site. It is also printed using Direct to Press equipment.

(The catalog does not have to go through a photographic stage but is downloaded in digital format directly to the printing press.)

The catalog cover photo was conceived by us and refined by the artistic talents of Ray Cherniak.

The cover photo was taken by Les Blackie and digitally modified.

This catalog will be reproduced on our web-site in Adobe Acrobat .pdf format for easy downloading.

Visit our Web Site at
<http://www.mode-elec.com>

Mode Electronics is proud to be ISO 9003 Certified.



MATCHING TRANSFORMER

Broadband (5-900Mhz) antenna matching transformer. 75-300Ω.



- | | |
|-----------------|---------|
| 16-109-0 | Bulk |
| 16-109-1 | Package |

COAXIAL SPLITTERS

5-900 Mhz bandwidth splitters. Diecast case with ground screw.



- | | |
|-----------------------------------|------------|
| 16-112-0 | 2-way Bulk |
| 16-113-0 | 3-way Bulk |
| 16-114-0 | 4-way Bulk |
| <i>Use -1 for Display Package</i> | |

DELUXE COAXIAL SPLITTERS

5-1000Mhz bandwidth splitters. Diecast case with ground screw. *We had these splitters tested by an independent engineer and he found them to be far superior to most splitters available.*



New Items

- | | |
|-----------------------------------|------------|
| 16-112A-0 | 2-way Bulk |
| 16-113A-0 | 3-way Bulk |
| 16-114A-0 | 4-way Bulk |
| <i>Use -1 for Display Package</i> | |

CATV WALL PLATE



Wall plates with double female F connector. Fits standard electrical outlet box, complete with screws.

- | | | |
|------------------|------|-------|
| 16-170-0 | Bulk | Beige |
| 16-170-1 | Pkg | Beige |
| 16-170W-0 | Bulk | White |
| 16-170W-1 | Pkg | White |

BLANK CATV WALL PLATE



Blank white wall plate. Fits standard electrical outlet box, complete with screws.

- | | |
|------------------|---------|
| 16-171W-0 | Bulk |
| 16-171W-1 | Package |

DUPLEX CATV WALL PLATE



Duplex white wall plate. Fits standard electrical outlet box, complete with screws.

- | | |
|------------------|---------|
| 16-172W-0 | Bulk |
| 16-172W-1 | Package |

BROADBAND AMPLIFIER

Single output CATV line amplifier.



Bandwidth: 50-900 Mhz.
Gain: (54-216 Mhz) 10db
(300 Mhz up) 7db

- | | |
|-----------------|---------|
| 16-411-0 | Bulk |
| 16-411-1 | Package |

TV SELECTOR SWITCH



Two way switch for 75Ω coaxial cable.

- | | |
|-----------------|---------|
| 16-902-0 | Bulk |
| 16-902-1 | Package |

BNC COAXIAL CABLES

BNC-BNC RG58/u coaxial cables.



- | | | |
|-----------------|------------|---------|
| 18-644-0 | 3' Length | Bulk |
| 18-644-1 | 3' Length | Package |
| 18-744-0 | 6' Length | Bulk |
| 18-744-1 | 6' Length | Package |
| 18-844-0 | 10' Length | Bulk |
| 18-844-1 | 10' Length | Package |

PC MOUNT 'F' JACKS



Straight PC mount 'F' jack.

- | | |
|-----------------|------|
| 21-062-0 | Bulk |
| 21-062-2 | Pkg. |

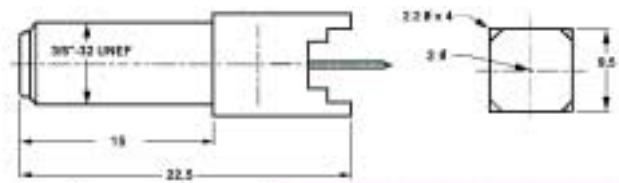

Right Angle PC mount 'F' Jack.

- | | |
|------------------|----------|
| 21-066-0 | Bulk |
| 21-066-2 | Pkg. |
| 21-066N-0 | Nut only |

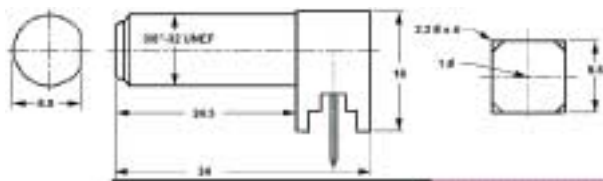

Visit our Web Site at
<http://www.mode-elec.com>

See PC Mount 'F' Jacks on previous page

'F' CONNECTORS



Standard crimp
 21-006-0 For RG6/u c/w ring
 21-006-2 Package
 21-006F-0 Crimp Ring



Integral crimp ring
 21-007-0 For RG6/u
 21-007-2 Package



Weatherproof
 21-008-0 For RG6/u
 21-008-2 Package
 'O' ring and silicone seal for weather resistance.

New Item



Push-on style
 21-050-0 For RG59/u
 21-050-2 Package



Screw-on style
 21-057-0 For RG59/u
 21-057-2 Package



Integral crimp ring
 21-058-0 For RG59/u
 21-058-2 Package



Standard crimp
 21-059-0 For RG59/u
 21-059-2 Package (2)
 21-059-10 Package (10)



21-059F-0 Crimp ring for 21-059-0



75Ω TERMINATOR
 21-060-0 Bulk
 21-060-2 Package



CHASSIS JACK
 21-061-0 Bulk
 21-061-2 Package



Double 'F' chassis jack.
 21-081-0 Bulk
 21-081-2 Package

Video and RF Adapters

F JACK  **RCA PLUG**
 21-115-0 Bulk
 21-115-1 Package

RCA PLUG  **F PLUG**
 21-116-0 Bulk
 21-116-1 Package

F JACK  **RCA JACK**
 21-125-0 Bulk
 21-125-1 Package

RCA JACK  **F PLUG**
 21-126-0 Bulk
 21-126-1 Package

BNC JACK  **RCA PLUG**
 21-131-0 Bulk
 21-131-1 Package

F JACK  **BNC JACK**
 21-135-0 Bulk
 21-135-1 Package

BNC JACK  **F PLUG**
 21-136-0 Bulk
 21-136-1 Package

RCA JACK  **BNC PLUG**
 21-142-0 Bulk
 21-142-1 Package

F JACK  **BNC PLUG**
 21-145-0 Bulk
 21-145-1 Package

F PLUG  **BNC PLUG**
 21-146-0 Bulk
 21-146-1 Package

BNC PLUG



UHF JACK

21-148-0 Bulk
21-148-1 Package

MINI UHF PLUG



UHF JACK

21-188-0 Bulk
21-188-1 Package

BNC PLUG



N JACK

21-149-0 Bulk
21-149-1 Package

N JACK



MINI UHF PLUG

21-189-0 Bulk
21-189-1 Package

RCA JACK



F PLUG

21-152-0 Bulk
21-152-1 Package

BNC JACK



SMA PLUG

21-190-0 Bulk
21-190-1 Package

F JACK



F PLUG

21-155-0 Bulk
21-155-1 Package

SMA JACK



BNC JACK

21-191-0 Bulk
21-191-1 Package

F JACK



F PLUG

21-156-0 Bulk
21-156-1 Package

BNC JACK



N PLUG

21-193-0 Bulk
21-193-1 Package

BNC JACK



UHF PLUG

21-173-0 Bulk
21-173-1 Package

BNC JACK



TNC PLUG

21-194-0 Bulk
21-194-1 Package

N JACK



UHF PLUG

21-179-0 Bulk
21-179-1 Package

UHF JACK



N PLUG

21-198-0 Bulk
21-198-1 Package

TNC JACK



MINI UHF PLUG

21-180-0 Bulk
21-180-1 Package

UHF JACK



TNC PLUG

21-199-0 Bulk
21-199-1 Package

MINI UHF JACK



UHF PLUG

21-187-0 Bulk
21-187-1 Package

UHF CONNECTORS

UHF SPECIFICATIONS

MATERIALS:

Body : Brass
 Contacts: Nickel plated brass
 Dielectric: Delrin

ELECTRICAL:

Nominal Impedance: Non constant
 Frequency Range: 0-500MHz
 Voltage Rating: 500VAC
 Withstanding Voltage: 1000V RMS
 Insulation Resistance: 5000MΩ min.



UHF CHASSIS JACK

21-238-0 Bulk
 21-238-1 Package



UHF CHASSIS JACK

21-239-0 Bulk
 21-239-1 Package

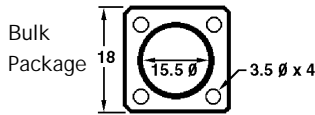

UHF STANDARD PLUG



For RG8/u - use reducing adapters below for RG58 or 59

21-259-0 Bulk
 21-259-1 Package



UHF REDUCING ADAPTER

21-260-0 RG58/u
 21-261-0 RG59/u
 Use -2 for Display Package



UHF TRIPLE JACK

21-264-0 Bulk
 21-264-1 Package



UHF 'T'

21-265-0 Bulk
 21-265-1 Package



MALE UHF JOINER

21-266-0 Bulk
 21-266-1 Package



UHF BULKHEAD MOUNT

50mm long with mtg. nuts
 21-267-0 Bulk
 21-267-1 Package



FEMALE UHF JOINER

21-268-0 Bulk
 21-268-1 Package



UHF RIGHT ANGLE

21-269-0 Bulk
 21-269-1 Package

BNC CONNECTORS

BNC SPECIFICATIONS

MATERIALS:

Body: Nickel plated brass
 Contacts: Gold plated brass or phosphor bronze
 Dielectric: Delrin

ELECTRICAL:

Nominal Impedance: 50Ω
 Frequency range: 0-4 GHz
 Voltage rating: 500VAC
 Withstanding voltage: 1500V RMS
 Insulation resistance: 5000MΩ min.

ISOLATED CHASSIS JACK

21-337-0 Bulk
 21-337-1 Package

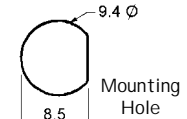

CHASSIS JACK



21-338-0 Bulk
 21-338-1 Package

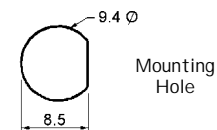

CRIMP PLUG



New 21-346-0 RG6/U
 21-348-0 RG58/u
 21-349-0 RG59/u
 Use -1 for Display Package



CRIMP JACK

21-350-0 Bulk
 21-350-1 Package
 for RG58/u

BNC TERMINATORS



21-351-0 50Ω
 21-352-0 75Ω
 Use -1 for Display Package

TWIST-ON PLUG



21-353-0 RG58/u
 21-354-0 RG59/u
 Use -1 for Display Package

STANDARD PLUG (Clamp Type)



21-358-0 RG58/u
 21-359-0 RG59/u
 Use -1 for Display Package



TRIPLE JACK

21-364-0 Bulk
 21-364-1 Package

'T' CONNECTOR



21-365-0 Bulk
21-365-1 Package

MALE JOINER



21-366-0 Bulk
21-366-1 Package

PANEL MOUNT JACK



21-367-0 Bulk
21-367-1 Package

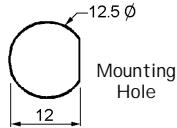

FEMALE JOINER



21-368-0 Bulk
21-368-1 Package

RIGHT ANGLE ELBOW



21-369-0 Bulk
21-369-1 Package

RUBBER CABLE BOOTS

These rubber boots for BNC crimp connectors provide a professional molded look to coaxial cables.



21-398-0 RG58/u
21-399-0 RG59/u
Use -6 for Display Package

N CONNECTORS

SPECIFICATIONS

MATERIALS:

Body: Nickel plated brass
Contacts: Gold plated brass or phosphor bronze
Dielectric: Delrin

ELECTRICAL:

Nominal Impedance: 50Ω
Frequency range: 0-4 GHz
Voltage rating: 500VAC
Withstanding voltage: 1500V RMS
Insulation resistance: 5000MΩ min.

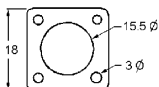

CHASSIS JACK

Mounting Holes 21-439-0 Bulk
21-439-1 Package

CRIMP/SOLDER PLUG (RG58/u)



21-450-0 Bulk
21-450-1 Package

Centre-pin soldered

N CONNECTORS cont'd

STANDARD PLUG (RG8/u)



21-457-0 Bulk
21-457-1 Package

STANDARD PLUG (RG58/u)



21-458-0 Bulk
21-458-1 Package

'T' CONNECTOR



21-465-0 Bulk
21-465-1 Package

MALE JOINER



21-466-0 Bulk
21-466-1 Package

FEMALE JOINER



21-468-0 Bulk
21-468-1 Package

RIGHT ANGLE ELBOW



21-469-0 Bulk
21-469-1 Package

Special Order Products
If you have a requirement for items not shown in this Catalog, please contact Mode or your local Distributor and we would be pleased to find an economical source.



Mode Electronics is proud to be ISO 9003 Certified.

MINI UHF CONNECTORS

MINI UHF SPECIFICATIONS

MATERIALS:

Body : Brass
 Contacts: Nickel plated brass
 Dielectric: Delrin

ELECTRICAL:

Nominal Impedance: Non constant
 Frequency Range: 0-2GHz
 Voltage Rating: 500VAC
 Withstanding Voltage: 1000V RMS
 Insulation Resistance: 5000M Ω min.

CHASSIS JACK



21-538-0 Bulk
 21-538-1 Package

CRIMP PLUG RG58/u



21-548-0 Bulk
 21-548-1 Package

'T' CONNECTOR



21-564-0 Bulk
 21-564-1 Package

'T' CONNECTOR



21-565-0 Bulk
 21-565-1 Package

MALE JOINER



21-566-0 Bulk
 21-566-1 Package

FEMALE JOINER



21-568-0 Bulk
 21-568-1 Package

RIGHT ANGLE ELBOW



21-569-0 Bulk
 21-569-1 Package

TNC CONNECTORS

TNC SPECIFICATIONS

MATERIALS:

Body: Nickel plated brass
 Contacts: Gold plated brass or phosphor bronze
 Dielectric: Delrin

ELECTRICAL:

Nominal Impedance: 50 Ω
 Frequency range: 0-4 GHz
 Voltage rating: 500VAC
 Withstanding voltage: 1500V RMS
 Insulation resistance: 5000M Ω min.

CRIMP CHASSIS JACK (RG58/u)



21-736-0 Bulk
 21-736-1 Package

CRIMP PLUG (RG58/u)



21-748-0 Bulk
 21-748-1 Package

CRIMP PLUG (RG59/u)



21-749-0 Bulk
 21-749-1 Package

STANDARD PLUG (RG58/u)



21-758-0 Bulk
 21-758-1 Package

FEMALE JOINER



21-768-0 Bulk
 21-768-1 Package

RIGHT ANGLE ELBOW



21-769-0 Bulk
 21-769-1 Package

SMA CONNECTORS

CRIMP PLUG FOR RG174/U



21-847-0 Bulk
 21-847-1 Package

CRIMP PLUG FOR RG58/U



21-848-0 Bulk
 21-848-1 Package

FEMALE JOINER



21-868-0 Bulk
 21-868-1 Package



24-100-0 Bulk
24-100-2 Pkg (2)

Metal body RCA plug. Maximum cable dia. 7.5mm



24-104-0 Bulk
24-104-2 Pkg (2)

Metal plug with strain relief. Maximum cable dia. 4.5mm



24-101-0 Black
24-102-0 Red
24-109-4 Pkg (4)

Colored plastic body RCA plugs. Max. cable dia. 4.5mm.



24-111-0 Black
24-112-0 Red
24-113-4 Pkg (4)

Colored plastic with strain relief. Max. cable dia. 4.5mm



24-114-0 Bulk
24-114-2 Pkg (2)

Black plastic right angle RCA plug. Max. cable dia. 5.1mm



24-116-0 Bulk
24-116-2 Pkg (2)

Crimp RCA plug for RG59/u



24-118-0 Bulk
24-118-1 Pkg

Precision machined RCA plug for RG58/u



24-120-0 Bulk
24-120-1 Pkg

Gold plated plug with spring strain relief. Cable dia 5.5mm



24-121-0 Black
24-122-0 Red
24-123-2 Pkg (2)

Color coded gold plated plugs. Max. cable dia. 5.0mm



24-124-0 Black
24-125-0 Red
24-126-2 Pkg (2)

Color coded gold plated plugs. Max cable dia. 6.0mm



24-150-0 Bulk
24-150-2 Pkg (2)

Metal body RCA jack. Max. cable dia. 7.5mm



24-151-0 Black
24-152-0 Red
24-159-2 Pkg (2)

Colored plastic RCA jacks. Max. cable dia. 5.0mm



24-161-0 Black
24-162-0 Red
24-163-2 Pkg (2)

Gold plated color coded jacks. Max. cable dia. 5.0mm



24-171-0 Bulk
24-171-6 Pkg (6)

Phenolic insulated RCA chassis jack. Mtg. holes 18mm C/C



24-172-0 Bulk
24-172-2 Pkg (2)

22 x 56mm. 48mm C/C mounting holes.

Phenolic insulated dual RCA jacks.



24-180-0 Bulk
24-180-2 Pkg (2)

Chassis mount RCA jack. 6mm mounting hole.



24-181-0 Bulk
24-181-2 Pkg (2)

Gold plated chassis RCA jack. 6mm mounting hole.

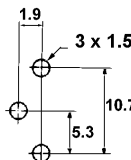

24-191-0 Bulk
24-191-2 Pkg (2)

PC mount RCA jack

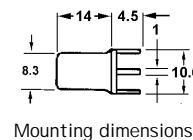

24-192-0 Bulk
24-192-2 Pkg (2)

PC mount RCA jack

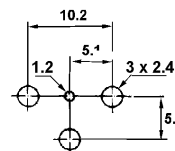

24-195-0 Bulk
24-195-2 Pkg (2)

Right angle PC mount RCA jack

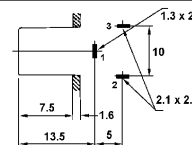

24-196-0 Bulk
24-196-2 Pkg (2)

Right angle PC mount RCA jack

Mode Electronics is proud to be ISO 9003 Certified.



2.5mm PLUGS



2.5mm mono plug. Maximum cable dia. 6mm



Mono plug 26mm long x 10mm dia. Cable dia. 5.5mm



Mono plug 48mm x 10mm dia. Cable diameter 4mm

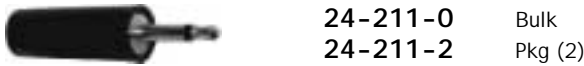

Mono plug 23 x 8mm dia. Cable diameter 4mm

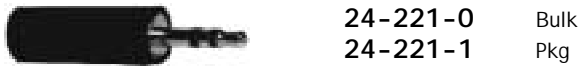

Stereo plug 22mm x 8.5mm dia. Cable diameter 4mm



Stereo plug 48mm x 10mm dia. Cable diameter 4mm

2.5mm JACKS



Inline mono jack Black color Cable dia. 6mm

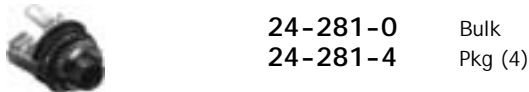

Mono chassis jack (closed circuit). 4mm mtg. hole

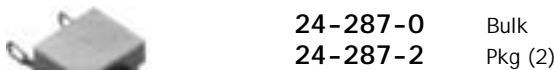
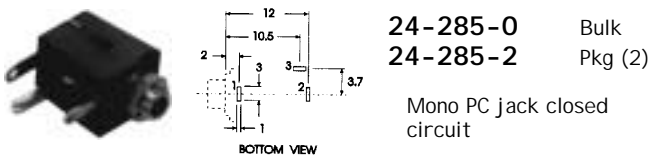

Mono chassis jack closed circuit. 4mm mtg. hole



Stereo chassis jack. 4mm mtg. hole

3.5mm PLUGS



Metal mono plug 25 x 9mm dia. Cable dia. 6.5mm



Mono plug 25 x 10mm diameter. Cable dia. 5mm



Red plastic mono plug. 25 x 10mm dia. Cable dia. 5mm



Mono plug 52 x 10mm dia. Cable dia. 4mm



Metal mono plug 53 x 9mm dia. Cable dia. 4.5mm

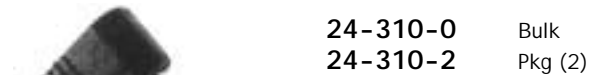

3.5mm mono right angle plug



Black mono plug 23 x 8mm dia. Cable dia. 4mm

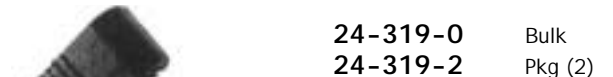

3.5mm stereo right angle plug



Metal stereo plug. 26mm x 9mm dia. Cable dia. 6.5mm



Black plastic stereo plug. 27 x 10mm dia. Cable 6mm dia.



Metal stereo plug. 52 x 9mm dia. Cable dia. 4.5mm



Black plastic stereo plug. 52 x 10mm dia. Cable dia. 4mm

1/4" JACKS



24-650-0	Bulk
24-650-1	Pkg

Mono inline jack. Cable dia. 6mm



24-652-0	Bulk
24-652-1	Pkg

Metal mono inline jack. Cable dia. 9mm



24-653-0	Bulk
24-653-1	Pkg

Metal mono inline jack. Cable diameter 6mm



24-670-0	Bulk
24-670-1	Pkg

Stereo inline jack. Cable dia. 6.0mm



24-671-0	Bulk
24-671-1	Pkg

Stereo inline jack. Cable dia. 7.5mm



24-672-0	Bulk
24-672-1	Pkg

Metal stereo inline jack. Cable diameter 9mm



24-673-0	Bulk
24-673-1	Pkg

Metal stereo inline jack. Cable dia. 6mm

1/4" CHASSIS JACKS



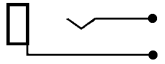

Mono chassis jack. 9mm mounting hole

	24-680-0	Bulk
	24-680-1	Pkg





Mono chassis jack with switch. 9mm mounting hole

	24-681-0	Bulk
	24-681-1	Pkg



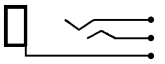

Stereo chassis jack. 9mm mounting hole

	24-690-0	Bulk
	24-690-1	Pkg

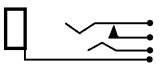

Stereo chassis jack. 9mm mounting hole

	24-691-0	Bulk
	24-691-1	Pkg

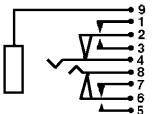

Stereo chassis jack with 2 SPDT switches. 9mm mtg. hole

	24-697-0	Bulk
	24-697-1	Pkg

DIN CONNECTORS

INLINE DIN JACKS



25-130-0	3-position
25-140-0	4-position
25-150-0	5-position
25-160-0	6-position
25-180-0	8-position

Use -1 for Display Package

INLINE DIN PLUGS



25-230-0	3-position
25-240-0	4-position
25-250-0	5-position
25-260-0	6-position
25-280-0	8-position

Use -1 for Display Package

CHASSIS MOUNT DIN JACKS

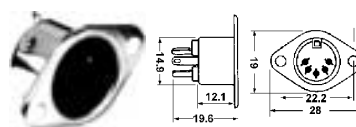

25-330-0	3-position
25-340-0	4-position
25-350-0	5-position
25-360-0	6-position
25-380-0	8-position

Use -1 for Display Package

SHIELDED PC MOUNT DIN JACK

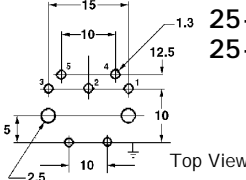
25-358-0	5-position
25-358-1	Pkg

PC MOUNT DIN JACK

25-359-0	5-position
25-359-1	Pkg

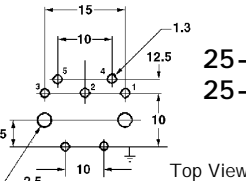
METAL INLINE DIN PLUG



25-450-0	5-pos.
25-450-1	Pkg

STANDARD 'DIN' PIN LAYOUTS

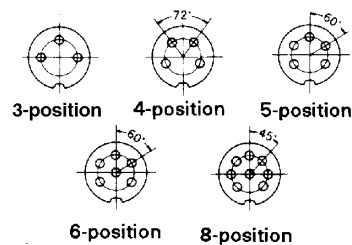

MINI DIN CONNECTORS

INLINE JACKS



26-140-0 4-position
26-160-0 6-position
26-180-0 8-position
Use -1 for Display Pkg.

INLINE PLUGS



26-240-0 4-position
26-250-0 5-position
26-260-0 6-position
26-280-0 8-position
Use -1 for Display Pkg.

PC MOUNT MINI DIN JACKS

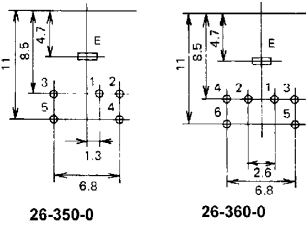

26-350-0 5-position
26-360-0 6-position
Use -1 for Display Pkg.

MICROPHONE CONNECTORS



25-513-0 3-pos jack
25-513-1 Pkg



25-515-0 5-pos jack
25-515-1 Pkg



25-523-0 3-pos plug
25-523-1 Pkg



25-525-0 5-pos plug
25-525-1 Pkg



25-533-0 3-pos. jack
25-533-1 Pkg



25-535-0 5-pos. jack
25-535-1 Pkg



25-543-0 3-pos. plug
25-543-1 Pkg



25-545-0 5-pos. plug
25-545-1 Pkg

INLINE PLUGS



25-722-0 2-position
25-723-0 3-position
25-724-0 4-position
25-725-0 5-position
25-726-0 6-position
25-728-0 8-position
Use -1 for Display Package

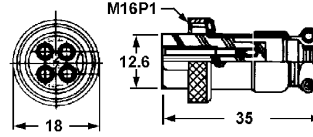

CHASSIS JACKS



25-732-0 2-position
25-733-0 3-position
25-734-0 4-position
25-735-0 5-position
25-736-0 6-position
25-738-0 8-position
Use -1 for Display Package

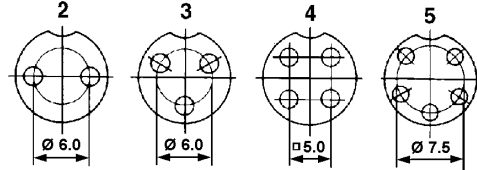
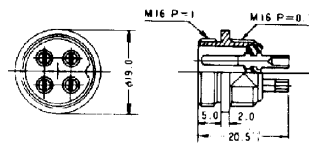

Pin Layout

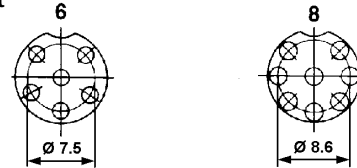

PRECISION MINIATURE CONNECTOR

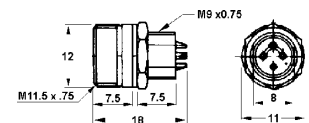
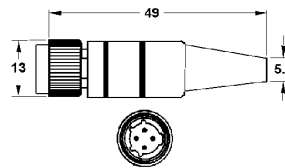

This miniature precision six contact connector features gold plated contacts, threaded locking ring and precision fit and finish.

25-746-0 6-position plug
25-746-1 Display Package
25-756-0 6-position jack
25-756-1 Display Package

	27-116-0 27-116-1	Bulk Pkg
RCA jack to RCA jack adapter.		
	27-117-0 27-117-1	Bulk Pkg
Gold plated RCA jack to RCA jack adapter.		
	27-132-0 27-132-1	Bulk Pkg
RCA jack to 3.5mm plug.		
	27-162-0 27-162-1	Bulk Pkg
RCA jack to 1/4" (6.35mm) phone plug.		
	27-312-0 27-312-1	Bulk Pkg
3.5mm jack to RCA plug.		
	27-322-0 27-322-1	Bulk Pkg
3.5mm jack to 2.5mm plug.		
	27-353-0 27-353-1	Bulk Pkg
3.5mm jack to 1/4" (6.35mm) stereo phone plug.		
	27-362-0 27-362-1	Bulk Pkg
3.5mm jack to 1/4" (6.35mm) mono phone plug.		
	27-434-0 27-434-1	Bulk Pkg
3.5mm stereo jack to 3.5mm mono plug.		
	27-455-0 27-455-1	Bulk Pkg
3.5mm stereo jack to 1/4" (6.35mm) stereo phone plug.		
	27-464-0 27-464-1	Bulk Pkg
3.5mm stereo jack to 1/4" (6.35mm) mono phone plug.		
	27-533-0 27-533-1	Bulk Pkg
1/4" (6.35mm) stereo jack to 3.5mm stereo plug.		
	27-534-0 27-534-1	Bulk Pkg
1/4" (6.35mm) stereo jack to 3.5mm mono plug.		
	27-564-0 27-564-1	Bulk Pkg
1/4" (6.35mm) stereo jack to 1/4" (6.35mm) mono plug.		
	27-612-0 27-612-1	Bulk Pkg
1/4" (6.35mm) mono jack to RCA plug.		
	27-632-0 27-632-1	Bulk Pkg
1/4" (6.35mm) mono jack to 3.5mm mono plug.		
	27-666-0 27-666-1	Bulk Pkg
1/4" (6.35mm) mono jack to 1/4" (6.35mm) mono jack.		

	27-913-0 27-913-1	Bulk Pkg
RCA 'Y' adapter.		
	27-933-0 27-933-1	Bulk Pkg
3.5mm stereo plug to 2 3.5mm stereo jacks		
RCA 'Y' CABLES		
	27-912-0	1 plug-2 jacks - 6" long
	27-921-0	1 jack-2 plugs - 6" long
<i>Use -1 for Display Package</i>		

MONO RCA CABLE		
	28-211-0 28-211-1	Bulk Pkg
6' long RCA plug to RCA plug.		

3.5mm CABLE		
	28-233-0 28-234-0*	Mono Bulk Stereo Bulk
6' long 3.5mm plug to 3.5mm plug.		
New Item *		
	28-233-1 28-234-1*	Pkg Pkg

STEREO AUDIO CABLES		
	28-511-0 28-611-0 28-711-0 28-811-0	3' long 6' long 12' long 20' long
Dual RCA plugs on both ends.		
	28-511-1 28-611-1 28-711-1 28-811-1	Pkg Pkg Pkg Pkg

GOLD PLATED STEREO AUDIO CABLES		
	28-512-0 28-612-0 28-712-0 28-812-0	3' long 6' long 12' long 20' long
Dual gold plated RCA plugs on both ends.		
	28-512-1 28-612-1 28-712-1 28-812-1	Pkg Pkg Pkg Pkg

GOLD PLATED VIDEO CABLES		
	28-412-0 28-413-0	6' long 12' long
Gold plated video cables - two audio lines plus shielded video line		
	28-412-1 28-413-1	Pkg Pkg

STEREO HEADPHONE EXTENSION		
	28-975-0 28-975-1	Bulk Pkg
Coiled 1/4" phone plug extension cord. Extends to 25'.		

D-SUB SPECIFICATIONS

MATERIALS

Shell: Yellow chromate or tin plated steel
 Contacts: Male - Brass (gold plated over nickel)
 Female - Gold plated phosphor bronze
 Insulator: PBT & glass-fibre reinforced UL94V-0

ELECTRICAL

Current rating: 3 amps
 Working voltage: 125V RMS
 Dielectric strength: 1000 volts for 1 minute
 Insulation resistance: 1000MΩ @ 500VDC
 Temperature range: -55 to +105 degrees C

SOLDER D-SUB CONNECTORS (MALE)



- 30-110-0** 9-position
 - 30-111-0** 15-position
 - 30-112-0** 25-position
 - 30-113-0** 37-position
 - 30-114-0** 50-position
- Use -1 for Display Package*

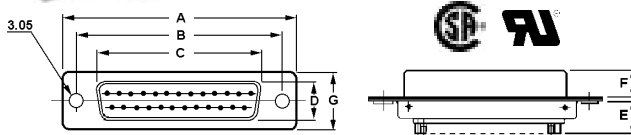

Size	A	B	C	D	E	F	G
9-pin	30.80	25.00	16.92	8.30	8.0	1.2	12.5
15-pin	39.20	33.30	25.25	8.30	8.0	1.2	12.5
25-pin	53.10	47.10	38.96	8.30	8.0	1.2	12.5
37-pin	69.40	63.50	55.42	8.30	8.0	1.2	12.5
50-pin	67.00	61.00	52.81	11.30	8.0	1.2	15.3

SOLDER D-SUB CONNECTORS (FEMALE)



- 30-120-0** 9-position
 - 30-121-0** 15-position
 - 30-122-0** 25-position
 - 30-123-0** 37-position
 - 30-124-0** 50-position
- Use -1 for Display Package*

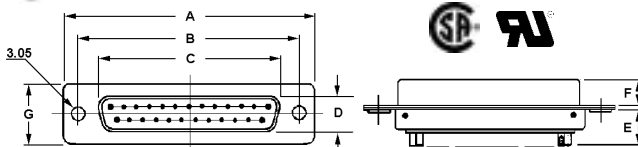

Size	A	B	C	D	E	F	G
9-pin	30.80	25.00	16.30	7.90	8.0	1.2	12.5
15-pin	39.20	33.30	24.60	7.90	8.0	1.2	12.5
25-pin	53.10	47.10	38.30	7.90	8.0	1.2	12.5
37-pin	69.40	63.50	54.80	7.90	8.0	1.2	12.5
50-pin	67.00	61.00	52.20	10.9	8.0	1.2	15.3

MACHINED CONTACT D-SUB (MALE)



- 30-140-0** 9-position
 - 30-141-0** 15-position
 - 30-142-0** 25-position
 - 30-143-0** 37-position
 - 30-144-0** 50-position
- Use -1 for Display Package*

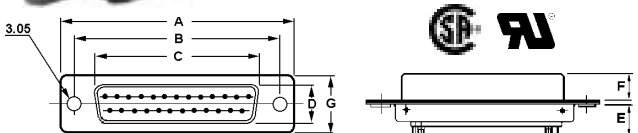

Size	A	B	C	D	E	F	G
9-pin	30.80	25.00	16.92	8.30	8.0	1.2	12.5
15-pin	39.20	33.30	25.25	8.30	8.0	1.2	12.5
25-pin	53.10	47.10	38.96	8.30	8.0	1.2	12.5
37-pin	69.40	63.50	55.42	8.30	8.0	1.2	12.5
50-pin	67.00	61.00	52.81	11.30	8.0	1.2	15.3

MACHINED CONTACT D-SUB (FEMALE)



- 30-150-0** 9-position
 - 30-151-0** 15-position
 - 30-152-0** 25-position
 - 30-153-0** 37-position
 - 30-154-0** 50-position
- Use -1 for Display Package*

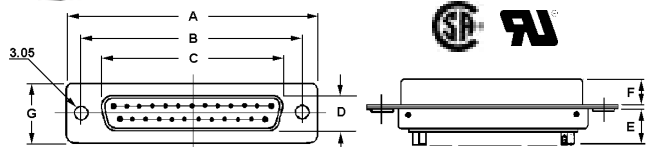

Size	A	B	C	D	E	F	G
9-pin	30.80	25.00	16.30	7.90	8.0	1.2	12.5
15-pin	39.20	33.30	24.60	7.90	8.0	1.2	12.5
25-pin	53.10	47.10	38.30	7.90	8.0	1.2	12.5
37-pin	69.40	63.50	54.80	7.90	8.0	1.2	12.5
50-pin	67.00	61.00	52.20	10.9	8.0	1.2	15.3

CRIMP D-SUB CONNECTORS (MALE)



- 30-210-0** 9-position
 - 30-211-0** 15-position
 - 30-212-0** 25-position
 - 30-213-0** 37-position
 - 30-214-0** 50-position
- Display package (-1) contains connector body plus contacts*

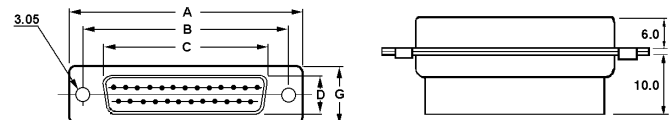

Size	A	B	C	D	G
9-pin	30.80	25.00	16.92	8.30	12.5
15-pin	39.20	33.30	25.25	8.30	12.5
25-pin	53.10	47.10	38.96	8.30	12.5
37-pin	69.40	63.50	55.42	8.30	12.5
50-pin	67.00	61.00	52.81	11.30	15.3

CRIMP D-SUB CONNECTORS (FEMALE)



- 30-220-0** 9-position
 - 30-221-0** 15-position
 - 30-222-0** 25-position
 - 30-223-0** 37-position
 - 30-224-0** 50-position
- Display package (-1) contains connector body plus contacts*

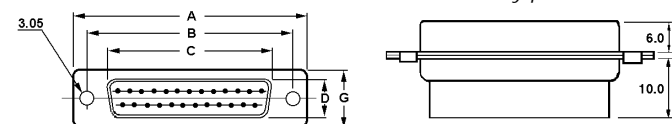

Size	A	B	C	D	G
9-pin	30.80	25.00	16.30	7.90	12.5
15-pin	39.20	33.30	24.60	7.90	12.5
25-pin	53.10	47.10	38.30	7.90	12.5
37-pin	69.40	63.50	54.80	7.90	12.5
50-pin	67.00	61.00	52.81	10.9	15.3

D-sub connectors and accessories are continued on pages 21 and 22.

Visit our Web Site at
<http://www.mode-elec.com>

CRIMP CONTACTS

Contacts for 30-21X and 30-22X series on previous page
Gold plated D-sub contacts. Available loose or on 5,000 pce. reels for machine application. Suitable for 20-24 AWG wire size.



30-226-0
30-227-0

Male contacts (loose)
Male contacts (5,000 reel)



30-228-0
30-229-0

Female contacts (loose)
Female contacts (5,000 reel)

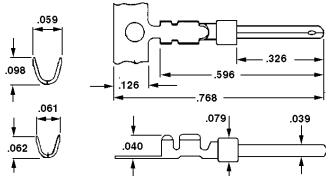

D-SUB HOODS



Grey plastic D-sub hoods complete with all hardware

30-130-0 9-position
30-131-0 15-position
30-132-0 25-position
30-133-0 37-position
30-134-0 50-position
Use -1 for Display Package

Chrome plated plastic D-sub hoods for EMI /RFI shielding



30-230-0 9-position
30-231-0 15-position
30-232-0 25-position
30-233-0 37-position
30-234-0 50-position
Use -1 for Display Package

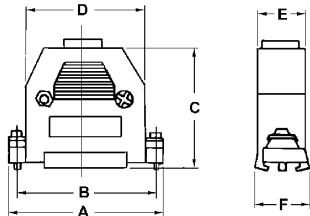

Size	A	B	C	D	E	F
9-pin	31.00	24.99	39.50	20.50	16.0	16.0
15-pin	39.00	33.32	35.50	28.00	16.0	16.0
25-pin	53.20	47.04	41.00	37.00	18.5	18.5
37-pin	72.00	63.50	42.00	51.00	23.0	23.0
50-pin	69.10	61.11	44.00	54.10	23.0	23.0

FEMALE LOCK POSTS



Locking hardware c/w nuts & washers (set of two)

30-023-0 Bulk only

MALE LOCK SCREWS



Locking screws c/w clip-on captivators (set of two)

30-028-0 Bulk only

PRINTED CIRCUIT MOUNT D-SUBS (MALE)



30-310-0 9-position
30-311-0 15-position
30-312-0 25-position
30-313-0 37-position
30-314-0 50-position
Use -1 for Display Package

PRINTED CIRCUIT MOUNT D-SUBS (FEMALE)



30-320-0 9-position
30-321-0 15-position
30-322-0 25-position
30-323-0 37-position
30-324-0 50-position
Use -1 for Display Package

Male dimensions

Size	A	B	C	D	E
9-pin	16.92	25.00	30.80	8.30	12.5
15-pin	25.25	33.30	39.20	8.30	12.5
25-pin	38.96	47.10	53.10	8.30	12.5
37-pin	55.42	63.50	69.40	8.30	12.5
50-pin	52.81	61.00	67.00	11.3	15.3

Female dimensions

Size	A	B	C	D	E
9-pin	16.30	25.00	30.80	7.90	12.5
15-pin	24.60	33.30	39.20	7.90	12.5
25-pin	38.30	47.10	53.10	7.90	12.5
37-pin	54.80	63.50	69.40	7.90	12.5
50-pin	52.20	61.00	67.00	10.9	15.3

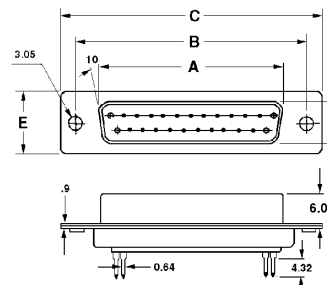

HIGH DENSITY SOLDER D-SUBS (MALE)



30-810-0 15-position
30-811-0 26-position
30-812-0 44-position
Use -1 for Display Package

Size	A	B	C
15-pos	16.92	25.00	30.8
26-pos	25.25	33.30	39.2
44-pos	38.96	47.10	53.1

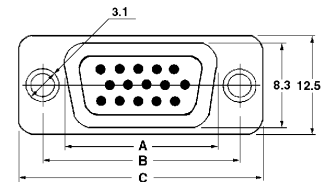

HIGH DENSITY SOLDER D-SUBS (FEMALE)



30-820-0 15-position
30-821-0 26-position
30-822-0 44-position
Use -1 for Display Package

Size	A	B	C
15-pos	16.30	25.00	30.8
26-pos	24.60	33.30	39.2
44-pos	38.30	47.10	53.1

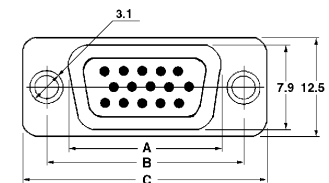

MALE LOCK POSTS

Knurled lock posts -use with hoods (set 2)



30-030-0 Bulk only

RIGHT ANGLE P.C. MOUNT D-SUB (MALE)

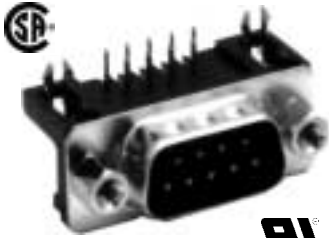

.318"/8.1mm footprint

- 30-410-0 9-position
 - 30-411-0 15-position
 - 30-412-0 25-position
 - 30-413-0 37-position
- Use -1 for Display Package

Size	A	B	C
9-pos	16.92	25.00	30.8
15-pos	25.25	33.30	39.2
25-pos	38.96	47.10	53.1
37-pos	55.42	63.50	69.4

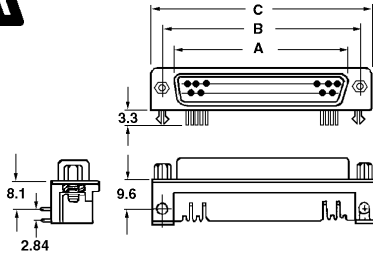

HIGH DENSITY R/A P.C. MOUNT D-SUBS (FEMALE)



- 30-860-0 15-position
 - 30-861-0 26-position
- Use -1 for Display Package

Size	A	B	C	D
15-pos	16.30	12.5	25.00	30.8
26-pos	24.60	12.5	33.30	39.2

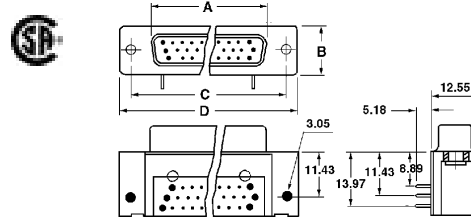

RIGHT ANGLE P.C. MOUNT D-SUB (FEMALE)

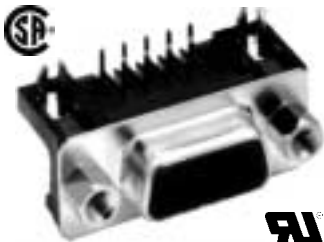

.318"/8.1mm footprint

- 30-420-0 9-position
 - 30-421-0 15-position
 - 30-422-0 25-position
 - 30-423-0 37-position
- Use -1 for Display Package

Size	A	B	C
9-pos	16.30	25.00	30.8
15-pos	24.60	33.30	39.2
25-pos	38.30	47.10	53.1
37-pos	54.80	63.50	69.4

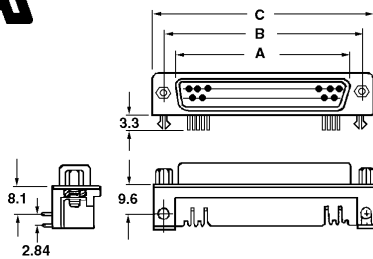

CENTRONICS CONNECTORS

CABLE PLUGS



- 30-902-0 36-position
 - 30-903-0 50-position
- Use -1 for Display Package

RIBBON CABLE PLUGS



- 30-942-0 36-position
 - 30-943-0 50-position
- Use -1 for Display Package

RIBBON CABLE RECEPTACLES



- 30-946-0 36-position
 - 30-947-0 50-position
- Use -1 for Display Package

RIBBON CABLE D-SUBS (MALE)



- 30-710-0 9-position
 - 30-711-0 15-position
 - 30-712-0 25-position
 - 30-713-0 37-position
- Use -1 for Display Package

Size	A	B	C
9-pos	16.92	25.00	30.8
15-pos	25.25	33.30	39.2
25-pos	38.96	47.10	53.1
37-pos	55.42	63.50	69.4

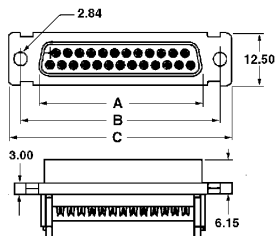

RIBBON CABLE D-SUBS (FEMALE)



- 30-720-0 9-position
 - 30-721-0 15-position
 - 30-722-0 25-position
 - 30-723-0 37-position
- Use -1 for Display Package

Size	A	B	C
9-pos	16.30	25.00	30.8
15-pos	24.60	33.30	39.2
25-pos	38.30	47.10	53.1
37-pos	54.80	63.50	69.4

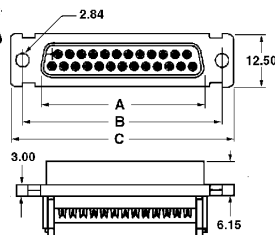

RIBBON CABLE



- 08-1410-100 10-conductor
- 08-1414-100 14-conductor
- 08-1416-100 16-conductor
- 08-1420-100 20-conductor
- 08-1425-100 25-conductor
- 08-1426-100 26-conductor
- 08-1434-100 34-conductor
- 08-1440-100 40-conductor
- 08-1450-100 50-conductor

Grey jacket 28 AWG stranded .050" ribbon cable. Available in 100' spools only. Rated 300V 105 degrees C. UL and CSA listed.



Mode Electronics is proud to be ISO 9003 Certified.



2/18 LINE CORDS (6' LONG)



3/18 SVT LINE CORD (6' LONG)



EQUIPMENT POWER CORD (6' LONG)

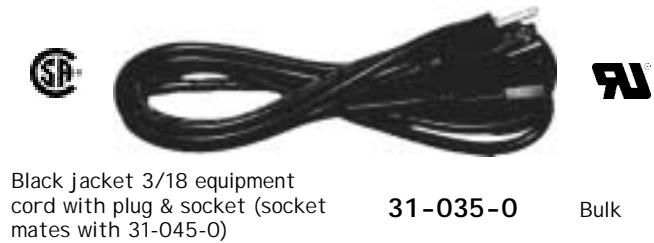

2-WIRE CHASSIS RECEPTACLE

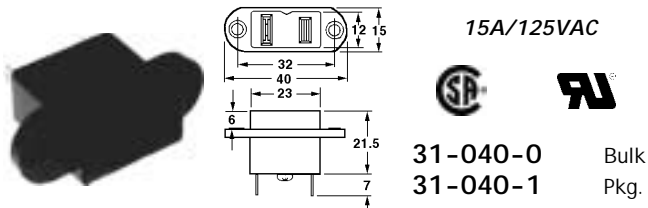

2-WIRE SNAP-IN RECEPTACLE

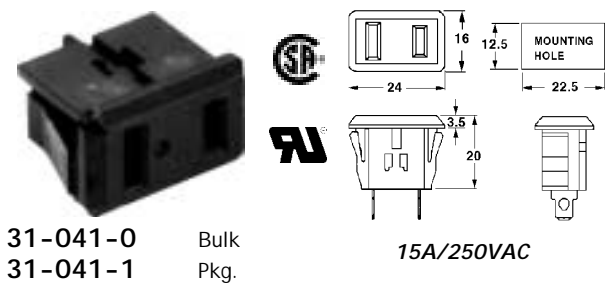

3-WIRE CHASSIS RECEPTACLE

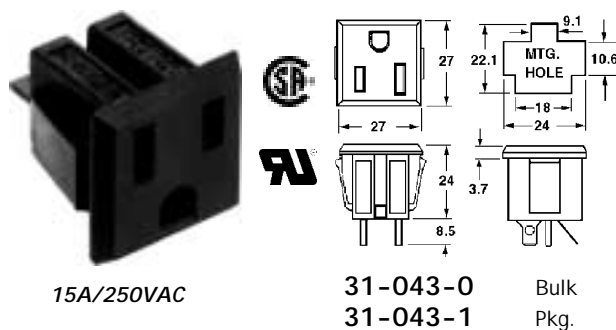

3-WIRE CHASSIS RECEPTACLE

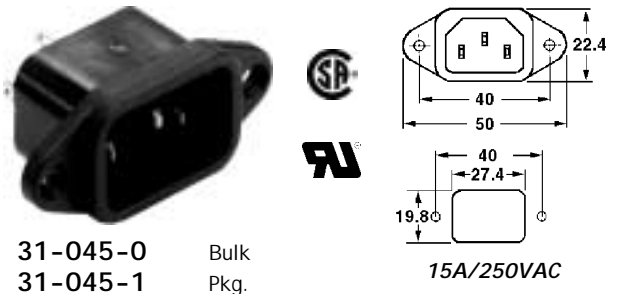

AC OUTLET STRIP

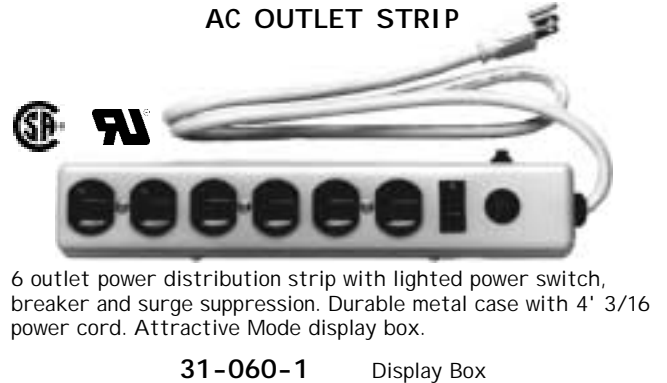

AC OUTLET STRIP New Item

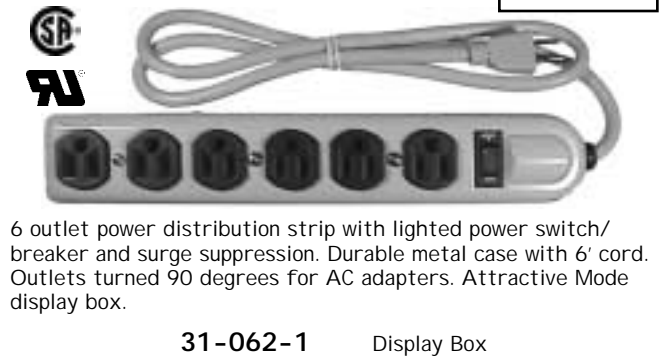

AC OUTLET STRIP New Item

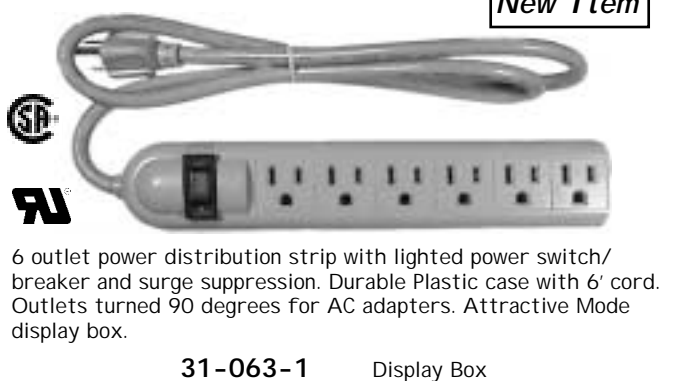

FEMALE AUTO POWER JACK



AUTO POWER PLUG c/w LED



Fuseable auto power plug with LED indicator.

- 31-085-0 Bulk
- 31-085-1 Pkg.

FUSED AUTO POWER PLUG



Auto cigarette lighter plug with fuse holder.

- 31-088-0 Bulk
- 31-088-1 Pkg.

STANDARD AUTO PLUG



Standard auto cigarette lighter plug.

- 31-089-0 Bulk
- 31-089-1 Pkg.



AUTO PLUG/CORD

New Item *

- 31-097-0 * 2.5mm R/A Plug/Fuse/LED 6' Cord Bulk
- 31-097-1 * 2.5mm R/A Plug/Fuse/LED 6' Cord Pkg
- 31-099-0 2.1mm Plug 8' cord Bulk
- 31-099-1 2.1mm Plug 8' cord Pkg.

DC POWER PLUGS



- 31-101-0 1.3mm
 - 31-121-0 2.1mm
 - 31-141-0 2.5mm
- Use -2 for Display Package

9mm barrel length 4 mm cable diameter



- 31-122-0 2.1mm
 - 31-142-0 2.5mm
- Use -2 for Display Package

14mm barrel length 4 mm cable diameter



- 31-123-0 2.1mm
 - 31-143-0 2.5mm
 - 31-161-0 3.0mm
- Use -2 for Display Package

9mm barrel length 4 .3mm cable diameter



- 31-124-0 2.1mm
 - 31-144-0 2.5mm
- Use -2 for Display Package

14mm barrel length 4 .3mm cable diameter

DC POWER JACKS



- 31-132-0 2.1mm
 - 31-152-0 2.5mm
- Use -1 for Display Package

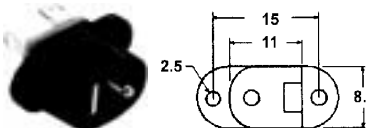

- 31-133-0 2.1mm
 - 31-153-0 2.5mm
- Use -2 for Display Package

13mm chassis mtg. hole.



- 31-134-0 2.1mm
 - 31-154-0 2.5mm
- Use -2 for Display Package

DC POWER JACKS cont'd



Compact isolated chassis mount DC power jack. 8mm mounting hole.

New Item

- 31-134M-0 2.1mm
 - 31-154M-0 2.5mm
- Use -2 for Display Package

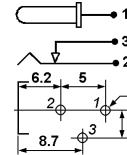

- 31-150-0 1.3mm
- Use -2 for Display Package

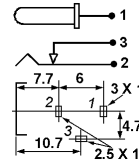

- 31-155-0 2.1mm
 - 31-155A-0* 2.1mm
 - 31-155S-0* 2.1mm
 - 31-156-0 2.5mm
 - 31-156S-0* 2.5mm
- Use -2 for Display Package

New Item

*

31-155-0 & 31-156-0 PET Material 230 deg. C
31-155A ABS Material 150 deg. C
31-155S & 31-156S Valox Material 250 deg. C

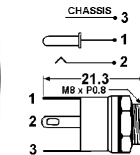

- 31-157-0 2.1mm
 - 31-158-0 2.5mm
- Use -1 for Display Package

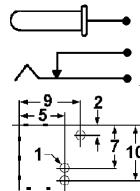

- 31-159-0 2.5mm
- Use -2 for Display Package

CHASSIS BANANA JACKS

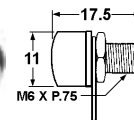

- 31-401-0 Black
- 31-402-0 Red
- 31-400-2 Pkg (2)

BINDING POSTS

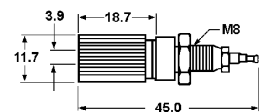

- 31-421-0 Black
- 31-422-0 Red
- 31-425-0 Green
- 31-420-2 Pkg (red & blk)

LOW PROFILE BINDING POSTS

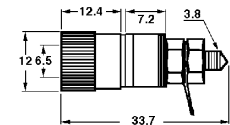

- 31-431-0 Black
- 31-432-0 Red
- 31-430-2 Pkg 1 red 1 black

BANANA PLUGS

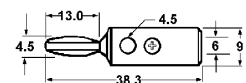

- 31-461-0 Black
- 31-462-0 Red
- 31-460-2 Pkg 1 red 1 black

COMPUTER ACCESSORIES



RS232 GENDER CHANGERS

Low profile gender changers with appropriate mounting hardware.

Positions	male-male	male-female	female-female
9-pos.	32-021-0	32-022-0	32-023-0
15-pos.	32-024-0	32-025-0	32-026-0
25-pos.	32-027-0	32-028-0	32-029-0

Use -1 for Display Package



CLIP LEAD SETS

Set of 10 heavy duty 30" clip leads with 50mm clips. 5 different colors.

33-220-0	Bulk set 10
33-220-10	Display Package



Set of 4 heavy duty 30" clip leads with 50mm clips. Colors: black, red, yellow, white.

33-230-0	Bulk set 4
33-230-4	Display Package

MODULAR PHONE JACK TO RS232 ADAPTERS



Note: RJ45(8C) types will accept RJ12(6C) plugs. RJ12 = 6P/6C RJ45 = 8P/8C

32-225-0	RJ12(6C) - 25 position male
32-226-0	RJ12(6C) - 25 position female
32-321-0	RJ45(8C) - 9-position male
32-322-0	RJ45(8C) - 9-position female
32-323-0	RJ45(8C) - 15-position male
32-324-0	RJ45(8C) - 15-position female
32-325-0	RJ45(8C) - 25-position male
32-326-0	RJ45(8C) - 25-position female

Use -1 for Display Package

SEIZER PROBES (55mm)



33-361-0	Black
33-362-0	Red
33-360-2	Pkg 1 red 1 black

32mm ALLIGATOR CLIPS



33-400-0	Bulk
33-400-10	Pkg 10

40mm INSULATED ALLIGATOR CLIPS



33-411-0	Bulk black
33-412-0	Bulk red
33-419-10	Pkg 5 red/black

32mm INSULATED ALLIGATOR CLIPS



Note: The 33-409-0 contains 10 assorted color clips, the -10 is a display package of 10.

33-409-0	Bulk
33-409-10	Pkg 10



IBM PARALLEL PRINTER CABLE

10' long IBM type molded printer cable

32-500-0	Bulk
32-500-1	Pkg

METER REPLACEMENT LEADS



Set of red & black test leads with pin type plugs. Plugs & probes are molded.

33-120-0	Set(bulk)
33-120-2	Package



Set of red & black test leads with banana plugs. Plugs & probes are molded.

33-140-0	Set(bulk)
33-140-2	Package

CLIP LEAD SETS



Set of 10 18" clip leads with 31mm insulated clips. 24 AWG stranded wires. Colors: 2 red, 2 black, 2 green, 2 yellow, 2 white

33-210-0	Bulk set 10
33-210-10	Display Package

51mm ALLIGATOR CLIPS (with screw)



33-430-0	Bulk
33-430-10	Pkg 10

51mm INSULATED ALLIGATOR CLIPS



33-431-0	Bulk black
33-432-0	Bulk red
33-439-10	Pkg 5 red/black

Visit our Web Site at <http://www.mode-elec.com>

NATURAL NYLON CABLE TIES



High quality nylon cable ties available in bags of 1000 or smaller quantity display packages.

	<u>Length</u>	<u>Width</u>	<u>Load</u>
34-121-100	3.5" (90mm)	2.4mm	8 Kg
34-121-1000			
34-122-100	4" (100mm)	2.5mm	8 Kg
34-122-1000			
34-123-100	5.5" (140mm)	3.6mm	18Kg
34-123-1000			
34-124-100	7.5" (188mm)	4.8mm	22Kg
34-124-1000			
34-125-100	8" (200mm)	4.8mm	22Kg
34-125-1000			
34-126-50	11" (300mm)	4.8mm	22kg
34-126-1000			

Note: -1000 are bulk packages of 1,000.
Others are Display Packages.

BLACK WEATHER RESISTANT CABLE TIES



High quality black nylon cable ties suitable for outdoor use. Available in bags of 1000 or smaller quantity display packages.

	<u>Length</u>	<u>Width</u>	<u>Load</u>
34-131-100	3.5" (90mm)	2.4mm	8 Kg
34-131-1000			
34-132-100	4" (100mm)	2.5mm	8 Kg
34-132-1000			
34-133-100	5.5" (140mm)	3.6mm	18Kg
34-133-1000			
34-134-50	7.5" (188mm)	4.8mm	22Kg
34-134-1000			
34-135-50	8" (200mm)	4.8mm	22Kg
34-135-1000			
34-136-25	11" (300mm)	4.8mm	22kg
34-136-1000			

Note: -1000 are bulk packages of 1,000.
Others are Display Packages.

SCREW MOUNT CABLE TIES



#8 screw hole

	<u>Length</u>	<u>Width</u>	<u>Load</u>
34-143-50	6" (150mm)	4.8mm	22kg
34-143-1000			
34-144-50	8" (200mm)	4.8mm	22kg
34-144-1000			
34-146-25	11" (300mm)	4.8mm	22kg
34-146-1000			

Note: -1000 are bulk packages of 1,000.
Others are Display Packages.

CABLE TIE TOOL



34-900-0 Bulk 34-900-1 Pkg.

Handy cable tie tensioner and cut-off tool. Made of very durable polymer material.

CABLE TIE MOUNTS (SCREW TYPE)



34-200 #6 screw



34-201 .188" mtg. hole

34-200-25 Disp. Pkg
34-201-25 Disp. Pkg

34-200-100 Bulk
34-201-100 Bulk

ADHESIVE CABLE TIE MOUNTS

34-210



3/4" Sq. adhesive mount.

34-212



1" Sq. adhesive #8 screw mount.

34-210-25 Disp. Pkg
34-212-25 Disp. Pkg

34-210-100 Bulk
34-212-100 Bulk

NYLON CABLE CLAMPS



34-300-100	1/8" diameter	Disp. Pkg
34-300-1000	1/8" diameter	Bulk
34-302-100	1/4" diameter	Disp. Pkg
34-302-1000	1/4" diameter	Bulk
34-304-100	3/8" diameter	Disp. Pkg
34-304-1000	3/8" diameter	Bulk
34-306-100	1/2" diameter	Disp. Pkg.
34-306-1000	1/2" diameter	Bulk
34-310-100	3/4" diameter	Disp. Pkg.

New Item

SPIRAL WRAP

Natural color polyethylene spiral wrap.
10 Meter rolls.



34-410-10M	1/8" - 1/2" dia.	Disp. Pkg
34-420-10M	1/4" - 2" dia.	Disp. Pkg
34-440-10M	3/8" - 3" dia.	Disp. Pkg
34-450-10M	1/2" - 4" dia.	Disp. Pkg.

Visit our Web Site at
<http://www.mode-elec.com>

FLEXIBLE GROMMET

Natural color polyethylene flexible grommet.
10 Meter rolls.

New Item



New Item

34-511-10M	1/32" chassis thickness	Disp. Pkg
34-512-10M	1/16" chassis thickness	Disp. Pkg
34-514-10M	3/32" chassis thickness	Disp. Pkg
34-515-10M	1/8" chassis thickness	Disp. Pkg.

FLEXIBLE CONDUIT

Black polypropylene flexible conduit. Split for easy wire insertion.

Note: Lengths vary as shown below.

New Item



New Item

34-521-300M	1/4" 300 meters	Bulk
34-521-30M	1/4" 30 meters	Bulk
34-521-10M	1/4" 10 meters	Bulk
34-522-200M	3/8" 200 meters	Bulk
34-522-30M	3/8" 30 meters	Bulk
34-522-10M	3/8" 10 meters	Bulk
34-523-200M	1/2" 200 meters	Bulk
34-523-30M	1/2" 30 meters	Bulk
34-523-10M	1/2" 10 meters	Bulk
34-524-100M	3/4" 100 meters	Bulk
34-524-30M	3/4" 30 meters	Bulk
34-524-10M	3/4" 10 meters	Bulk.
34-525-100M	1" 100 meters	Bulk
34-525-30M	1" 30 meters	Bulk
34-525-10M	1" 10 meters	Bulk

SNAP-IN BUSHINGS

94V-2 black nylon snap-n bushings

New Item



New Item

34-622-0	for 3/8" hole	Bulk
34-622-50	for 3/8" hole	Pkg. 50
34-623-0	for 1/2" hole	Bulk
34-623-50	for 1/2" hole	Pkg. 50
34-624-0	for 5/8" hole	Bulk
34-624-50	for 5/8" hole	Pkg. 50
34-625-0	for 3/4" hole	Bulk
34-625-25	for 3/4" hole	Pkg. 25
34-626-0	for 7/8" hole	Bulk
34-626-25	for 7/8" hole	Pkg. 25
34-627-0	for 1" hole	Bulk
34-627-25	for 1" hole	Pkg. 25

New ★ HOLE PLUGS

94V-2 black nylon hole plugs

New Item



New Item

34-612-0	for 3/8" hole	Bulk
34-612-50	for 3/8" hole	Pkg. 50
34-613-0	for 1/2" hole	Bulk
34-613-50	for 1/2" hole	Pkg. 50
34-614-0	for 5/8" hole	Bulk
34-614-50	for 5/8" hole	Pkg. 50
34-615-0	for 3/4" hole	Bulk
34-615-25	for 3/4" hole	Pkg. 25
34-616-0	for 7/8" hole	Bulk
34-616-25	for 7/8" hole	Pkg. 25
34-617-0	for 1" hole	Bulk
34-617-25	for 1" hole	Pkg. 25

STRAIN RELIEF BUSHINGS

94V-2 black nylon strain relief bushings

New Item



34-630-0	SPT-1 18/2 Right Angle .1" chassis	Bulk
34-631-0	SPT-1 18/2 .062" chassis	Bulk
34-632-0	SPT-1 18/2 .100" chassis	Bulk
34-633-0	SVT 18/3 .062" chassis	Bulk
34-634-0	SVT 18/3 .100" chassis	Bulk
34-635-0	SJT 18/3 .062" chassis	Bulk
34-636-0	SJT 18/3 .100" chassis	Bulk

Available in Bulk only

STRAIN RELIEF INSTALLATION TOOL

New Item



34-901-1	Installation Tool	Disp. Pkg.
-----------------	-------------------	------------

Mode Electronics is proud to be ISO 9003 Certified.



.062" CONTACT CONNECTORS



Plug	Receptacle	Package	Contacts
37-002-0	37-102-0	37-202-2	2
37-003-0	37-103-0	37-203-2	3
37-004-0	37-104-0	37-204-1	4
37-005-0	37-105-0	37-205-1	5
37-006-0	37-106-0	37-206-1	6
37-009-0	37-109-0	37-209-1	9
37-012-0	37-112-0	37-212-1	12

Package contains 1 or 2 plugs, receptacles and contacts



37-910-0

Female contacts 18-24 AWG



37-900-0

Male contacts 18-24 AWG

.093" CONTACT CONNECTORS

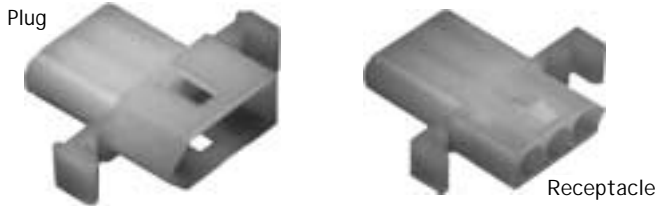

Plug	Receptacle	Package	Contacts
37-302-0	37-402-0	37-502-2	2
37-303-0	37-403-0	37-503-1	3
37-304-0	37-404-0	37-504-1	4
37-306-0	37-406-0	37-506-1	6
37-309-0	37-409-0	37-509-1	9
37-312-0	37-412-0	37-512-1	12

Package contains plug, receptacle and contacts



37-940-0

Female contacts 18-22 AWG



37-930-0

Male contacts 18-22 AWG

.100" WIRE CONNECTORS

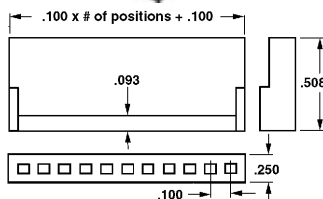

37-602-0	2-position
37-603-0	3-position
37-604-0	4-position
37-605-0	5-position
37-606-0	6-position
37-608-0	8-position
37-609-0	9-position

37-960-0 Bulk 22-28 AWG contacts



See the following page as well as the tool section starting on Page 55 for crimp tools and insertion/extraction tools for the crimp contacts shown on this page.

New Item

.100" PC HEADERS

Straight PC headers for 37-60X series. .64mm PC posts.

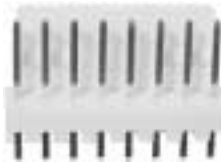

37-6202-0	2-position
37-6203-0	3-position
37-6204-0	4-position
37-6205-0	5-position
37-6206-0	6-position
37-6208-0	8-position

Right angle PC headers for 37-60X series. .64mm PC posts.

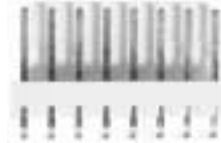

37-6302-0	2-position
37-6303-0	3-position
37-6304-0	4-position
37-6305-0	5-position
37-6306-0	6-position
37-6308-0	8-position

New Item

.156" WIRE CONNECTORS



37-970-0

Bulk 18-22AWG contacts

37-702-0	2-position
37-704-0	4-position
37-706-0	6-position
37-708-0	8-position
37-710-0	10-position

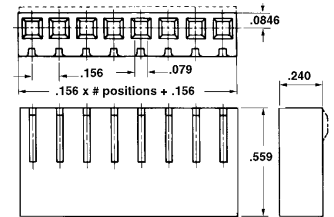

New Item

.156" PC HEADERS

Straight PC headers for 37-70X series. 1.14mm PC posts.

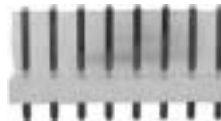

37-7202-0	2-position
37-7204-0	4-position
37-7206-0	6-position
37-7208-0	8-position
37-7210-0	10-position

New Item

Right Angle PC headers for 37-70X series. 1.14mm PC posts.

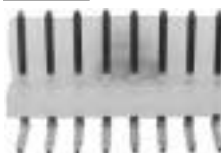

37-7302-0	2-position
37-7304-0	4-position
37-7306-0	6-position
37-7308-0	8-position
37-7310-0	10-position

New Item

EXTRACTION TOOL



37-950-1 Pkg.
Extraction tool for .093" terminals. (37-930-0, 940)

37-951-1 Pkg.
Extraction tool for .062" terminals. (37-910-0, 900)

New Item

TERMINAL CRIMP TOOL

TERMINAL CRIMP TOOL



84-200-1
This crimp tool can be used for the 37-900-0 and 37-910-0 .093" terminals

A complete selection of tools is shown on Pages 55 to 58.

New Item



New Item

84-199-1
This crimp tool can be used for the 37-930-0 and 37-940-0 .093" terminals

DUAL WIPE STANDARD I.C. SOCKETS

30% glass filled polyester UL94V-0 insulator. Contacts: phosphor bronze with 50 microinches hot tin dip.

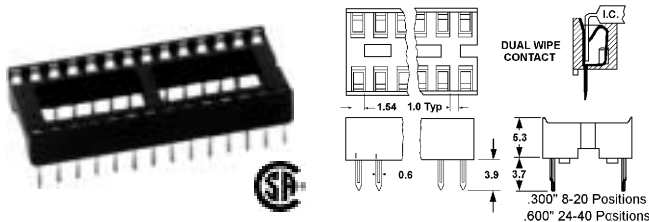

Bulk	Package	Pins
39-008-0	39-008-10	8-position
39-014-0	39-014-6	14-position
39-016-0	39-016-5	16-position
39-018-0	39-018-4	18-position
39-020-0	39-020-4	20-position
39-024-0	39-024-3	24-position
39-028-0	39-028-3	28-position
39-032-0	39-032-3	32-position
39-040-0	39-040-2	40-position

DIP RIBBON CONNECTORS

UL94V-0 40% glass fibre PBT, 10 micro inches gold plating.

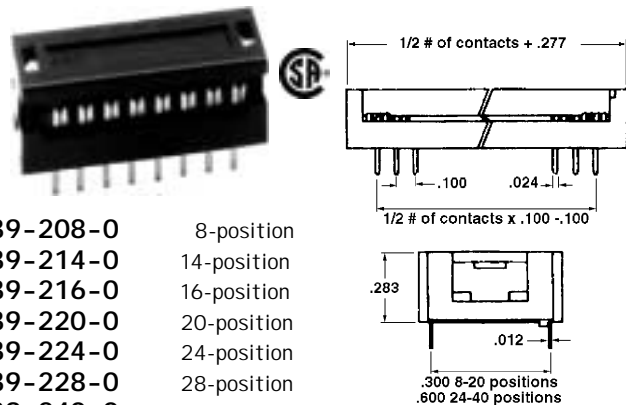

39-208-0	8-position
39-214-0	14-position
39-216-0	16-position
39-220-0	20-position
39-224-0	24-position
39-228-0	28-position
39-240-0	40-position

PLCC SOCKETS

94V-0 glass filled thermoplastic, tin plated contacts.

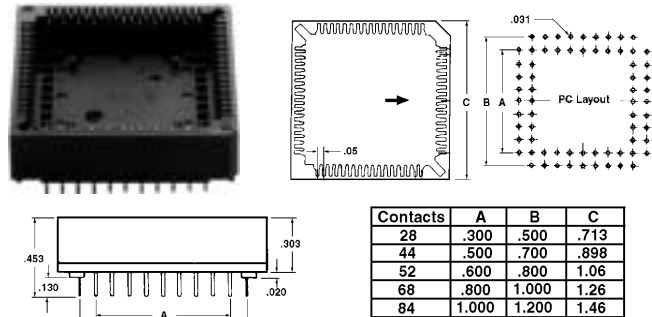

Bulk	Package	Pins
39-328-0	39-328-1	28-position
39-344-0	39-344-1	44-position
39-352-0	39-352-1	52-position
39-368-0	39-368-1	68-position
39-384-0	39-384-1	84-position

MACHINED CONTACT I.C. SOCKETS

94V-0 PBT insulator 15 micro inch gold plated contact area.

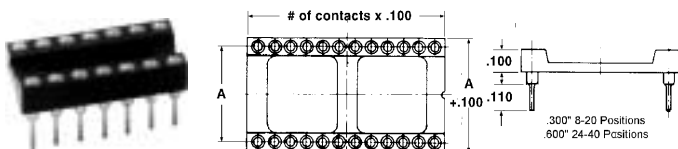

Bulk	Package	Pins
39-108-0	39-108-3	8-position
39-114-0	39-114-2	14-position
39-116-0	39-116-2	16-position
39-140-0	39-140-1	40-position

ULTRA MINIATURE TOGGLE SWITCHES (3A @ 125VAC)



Single Pole

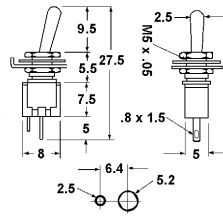

- 41-310-0 SPST on-off
 - 41-313-0 SPDT on-on
 - 41-323-0 DPDT on-on
- Use -1 for Display Package*



Double Pole

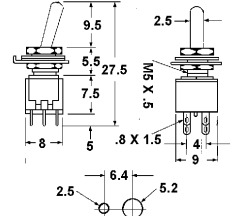

BAT HANDLE SUB-MINIATURE TOGGLE SWITCH (6A @ 125VAC)



- 41-513-0 SPDT on-on
 - 41-523-0 DPDT on-on
 - 41-525-0 DPDT on-off-on
- Use -1 for Display Package*

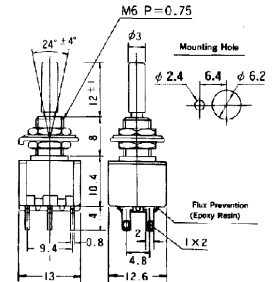
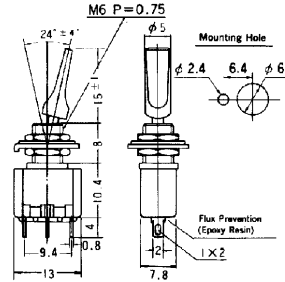

COLORED VINYL CAPS

For Sub-Miniature Toggle Switches



- 41-901-0 Black
- 41-902-0 Red
- 41-904-0 Yellow
- 41-906-0 Blue
- 41-909-0 White

WATERPROOF BOOTS

M6.3 size for North American made switches -M6 for offshore made switches.



- 41-899-0 M6.3 x .635 thread Package 3
- 41-899-3 M6.3 x .635 thread Package 3
- 41-900-0 M6 x 0.75 thread Package 3
- 41-900-3 M6 x 0.75 thread Package 3

STANDARD TOGGLE SWITCHES



3A @ 125V (1.5A @ 250V) with solder terminals.

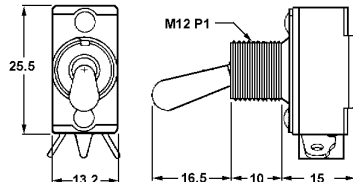

- 42-010-0 SPST on-off
- 42-010-1 Display Package

10 amp @ 125VAC (6 amp @ 250VAC)
Solder terminals and dress panel nut.

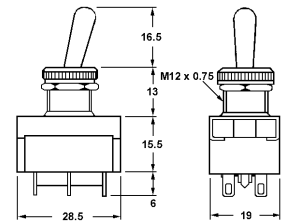

- 42-113-0 SPDT on-on
 - 42-115-0 SPDT on-off-on
 - 42-123-0 DPDT on-on
- Use -1 for Display Package*

10 amp @ 125VAC (6 amp @ 250VAC)
Solder terminals and dress panel nut.

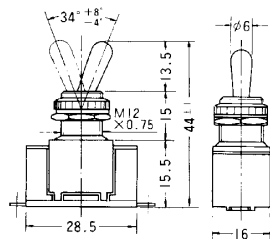

- 42-110-0 SPST on-off
- 42-110-1 Display Package

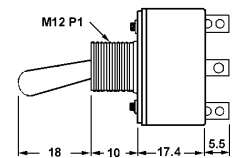
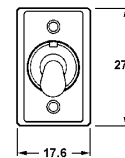

- 42-130-0 DPST on-off 5A/125V CSA
- 42-143-0 DPDT on-on 5A/125V CSA
- 42-145-0 DPDT on-off-on 5A/125V CSA/UL

Use -1 for Display Package

TOGGLE SWITCHES



3A @ 125V

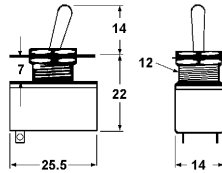

42-210-0 SPST on-off
42-210-1 Display Package

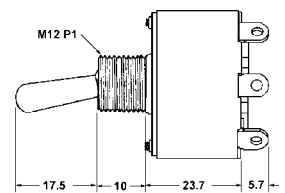
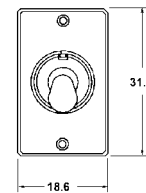

NKK

AS NOTED



42-340-0 DPDT on-on 10A/125VAC (10A/30VDC) CSA/UL
42-543-0 DPDT on-on 20A/125VAC (20A/30VDC) CSA/UL
42-545-0 DPDT on-off-on 20A/125VAC (20A/30VDC) CSA
Use -1 for Display Package



6A @ 125V

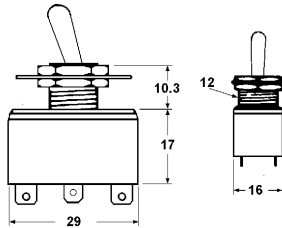

42-223-0 DPDT on-on
42-223-1 Display Package

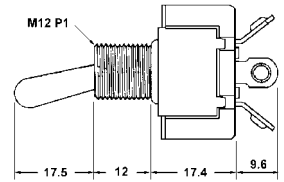
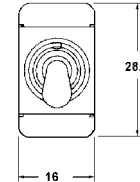

NKK

AS NOTED



15A/125V 6A/250VAC(20A/30VDC)

42-410-0 SPST on-off CSA/UL
42-424N-0 SPDT on-on CSA/UL
42-424-0 SPDT on-(on) CSA
42-425B-0 SPDT on-off-on CSA/UL
42-426-0 SPDT on-off-(on) CSA
42-427-0 SPDT (on)-off-(on) CSA

Use -1 for Display Package



6A @ 125V

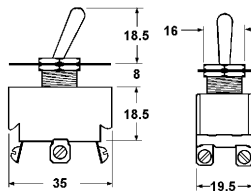

42-225-0 DPDT on-off-on
42-225-1 Display Package



10A @ 125V
(6A @ 250V)

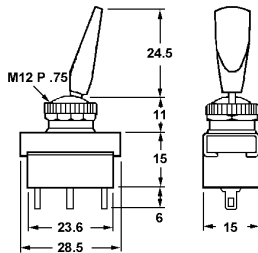

Black plastic bat handle. Solder terminals.

42-310-0 SPST on-off
42-323-0 DPDT on-on
Use -1 for Display Package

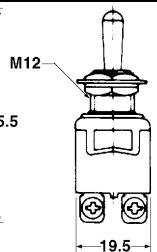
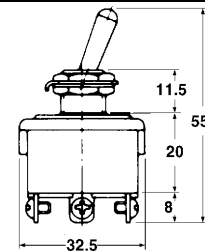

Rating: 15A/125V 10A/250V screw terminals

42-413-0 SPDT on-on
42-415-0 SPDT on-off-on
42-423-0 DPDT on-on
42-425-0 DPDT on-off-on

Use -1 for Display Package

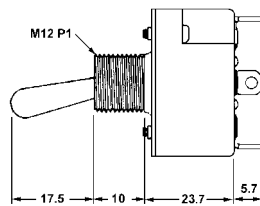
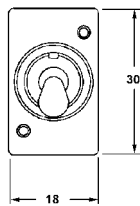

AS NOTED

NKK

42-310N-0 SPST on-off 10A/125VAC (10A/30VDC) CSA/UL
42-323N-0 SPDT on-on 10A/125VAC (10A/30VDC) UL
42-410N-0 SPST on-off 15A/125VAC (20A/30VDC) CSA/UL
Same style switch but with .250" faston terminals no UL or CSA approvals.
42-423N-0 SPDT on-on 15A/125VAC (20A/30VDC)
42-425N-0 SPDT on-off-on 15A/125VAC (20A/30VDC)
Use -1 for Display Package

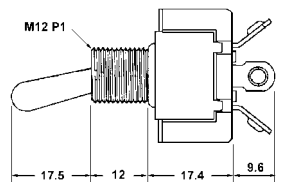
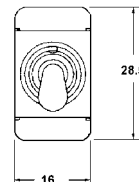

NKK

AS NOTED



15A/125V 6A/250VAC(20A/30VDC) screw terminals

42-423S-0 SPDT on-on CSA/UL
42-424S-0 SPDT on-(on) CSA/UL
42-425S-0 SPDT on-off-on CSA
42-426S-0 SPDT on-off-(on) CSA/UL
42-427S-0 SPDT (on)-off-(on) CSA

Use -1 for Display Package

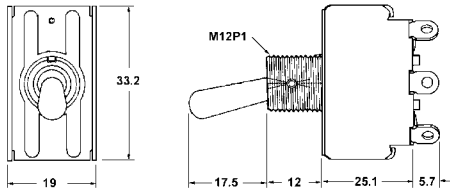

NKK AS NOTED **SA** **RU**

- 42-444-0 DPDT on-(on) 15A/125VAC (20A/30VDC) CSA/UL
 - 42-446-0 DPDT on-off-(on) 15A/125VAC (20A/30VDC) UL
 - 42-447-0 DPDT (on)-off-(on) 15A/125VAC (20A/30VDC) UL
 - 42-630-0 DPST on-off 25A/125VAC (25A/30VDC) CSA
 - 42-643-0 DPDT on-on 25A/125VAC (25A/30VDC) CSA
 - 42-645-0 DPDT on-off-on 25A/125VAC (25A/30VDC) CSA
- Use -1 for Display Package

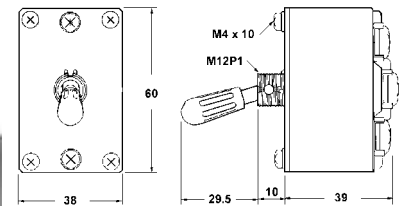

NKK

50 Amp @ 125VAC

These high capacity switches are designed to protect contacts by extinguishing the arc which occurs at break. Bar magnets are placed at each end of the switch and their magnetic field opposes the field created by the arcing current, thereby extinguishing the arc.

- 42-843-0 DPDT 50A/125VAC(50A/30VDC)
- Use -1 for Display Package

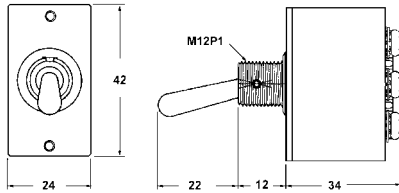

NKK **SA** **RU**

- 42-670-0 4PST on-off 25A/125VA (20A/30VDC)
 - 42-683-0 4PDT on-on 25A/125VAC (20A/30VDC)
 - 42-685-0 4PDT on-off-on 25A/125VAC (20A/30VDC)
- Use -1 for Display Package

PUSHBUTTON SWITCHES

6 Amp @250VAC (10A @ 125VAC) with black button.

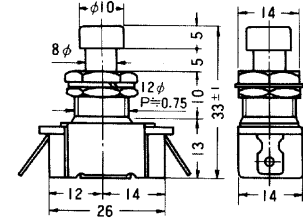

- 44-110-0 SPST on-off Bulk
- 44-110-1 Pkg

6 Amp @ 250VAC (10 Amp @ 125VAC) with chrome button.

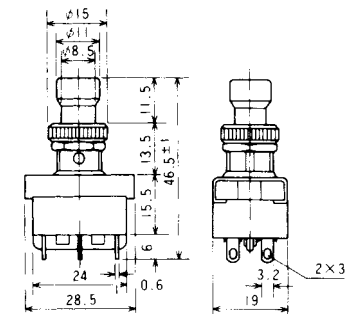

- Alternate Action
- 44-123-0 DPDT on-on Bulk
- 44-123-1 Pkg

3 Amp @ 125VAC with black button

WATERPROOF BOOTS



- 42-900-0 for M12 P1 thread
- 42-900-1 Pkg.

SWITCH PLATE

- 42-901-0 on-off switchplate for M12 barrel

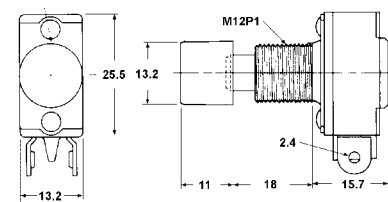

NKK



- 44-201-0 SPST off-(on) N/O Bulk
 - 44-202-0 SPST on-(off) N/C Bulk
- Use -1 for Display Package

PUSHBUTTON SWITCHES



15 Amp @125VAC or 250VAC (1/2 HP). Very long life micro switch with black button.

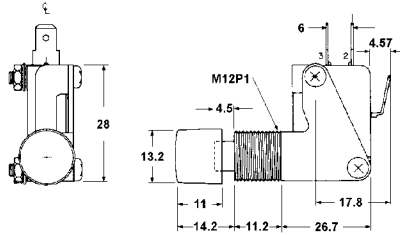

OMRON



44-241-0
44-241-1

SPDT on-(on)

Bulk
Pkg

15 Amp @ 125VAC (9 Amp @ 250VAC) with black button.

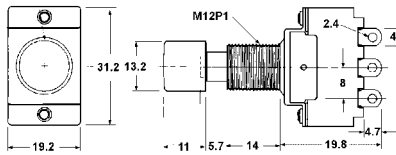

OMRON



44-250-0
44-250-1

DPDT on-on

Bulk
Pkg



3A @ 125VAC

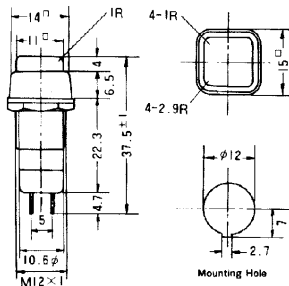

44-480-0 SPST off-(on) N/O red button
44-481-0 SPST off-(on) N/O black button
44-482-0 SPST off-on red button
44-483-0 SPST on-(off) N/C red button

Use -1 for Display Package



3A @ 125VAC
12mm mounting hole

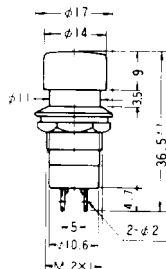

44-490-0 SPST off-on black button
44-491-0 SPST off-(on) N/O red button
44-492-0 SPST off-(on) N/O black button
44-493-0 SPST off-on red button

Use -1 for Display Package



3A @ 125VAC
16mm mounting hole
snap-in mounting.

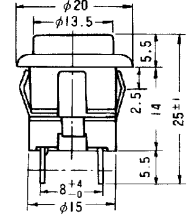

44-530-0 SPST off-(on) N/O white button
44-531-0 SPST off-(on) N/O black button
44-532-0 SPST off-(on) N/O red button

Use -1 for Display Package

.5A @ 125VAC Ultra-miniature pushbutton switch

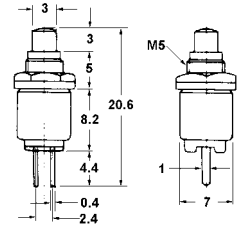

44-541-0 SPST off-(on) N/O black button
44-542-0 SPST off-(on) N/O red button

Use -1 for Display Package



1 A @ 125VAC

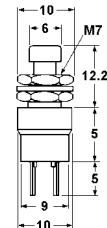

44-551-0 SPST off-(on) N/O black button
44-552-0 SPST off-(on) N/O red button
44-553-0 SPST on-(off) N/C black button
44-554-0 SPST on-(off) N/C red button

Use -1 for Display Package



1 A @ 125VAC

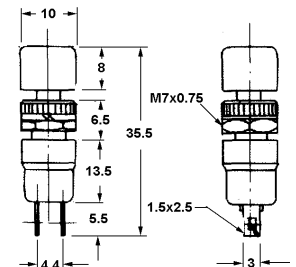

44-570-0 SPST on-(off) N/C red button
44-571-0 SPST on-(off) N/C black button
44-572-0 SPST off-(on) N/O red button
44-573-0 SPST off-(on) N/O black button

Use -1 for Display Package



6A @ 125VAC

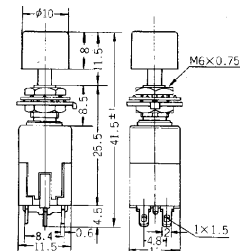

44-611-0 DPDT on-on black button
44-622-0 SPDT on-on red button

Use -1 for Display Package

SLIDE SWITCHES

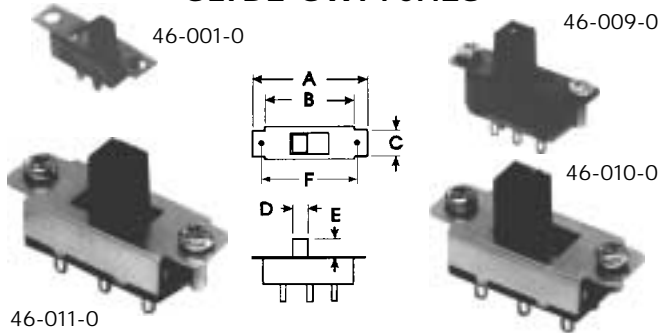

Bulk #	Pkg. #	Current	Poles	Switch	A	B	C	D	E	F
46-001-0	-2	.3A	SPDT	on-on	19	15	5.4	3.2	4	15
46-009-0	-2	.3A	DPDT	on-on	23	19	7.5	4.5	8	19
46-010-0	-2	1A	DPDT	on-on	35	28	13	7	7	31
46-011-0	-2	1A	DPDT	on-off-on	38	32	13	7	7	34

Current ratings are at 125VAC. Dimensions are in mm.

ROCKER SWITCHES

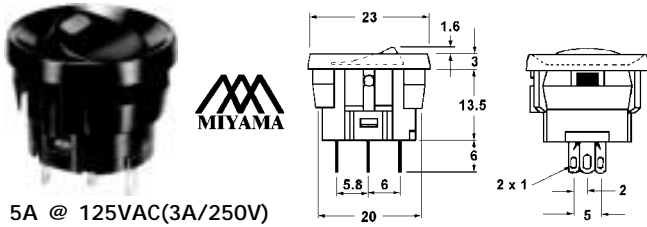

5A @ 125VAC(3A/250V)

Single hole snap-in mount with LED indicator.
LED requires external limit resistor.

- 46-102-0 SPST on-off black button red LED
- 46-103-0 SPST on-off black button green LED
- 46-104-0 SPST on-off black button yellow LED

Use -1 for Display Package

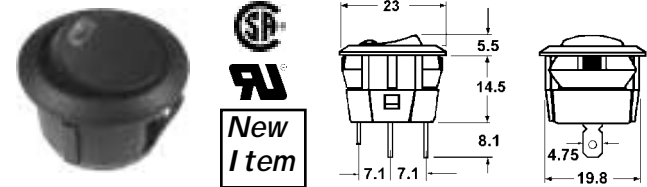

10A @ 125VAC(6A/250V)

Single hole snap-in mount with LED indicator.
LED requires external limit resistor.

- 46-102J-0 SPST on-off black button red LED
- 46-103J-0 SPST on-off black button green LED
- 46-104J-0 SPST on-off black button yellow LED

Use -1 for Display Package

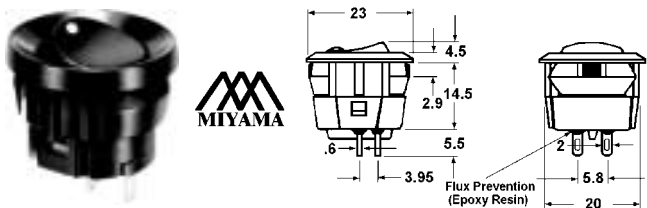

Single hole snap-in mount. 5A @ 125VAC (3A @ 250VAC)

- 46-100-0 SPST on-off black button white dot
- 46-101-0 SPST on-off red button white dot
- 46-108-0 SPDT on-on black button white dot
- 46-124-0 DPDT on-on black button white dot

Use -1 for Display Package

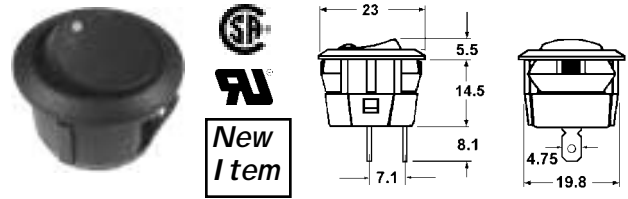

Single hole snap-in mount. 10A @ 125VAC (6A @ 250VAC)

- 46-100J-0 SPST on-off black button white dot
- 46-108J-0 SPDT on-on black button white dot

Use -1 for Display Package

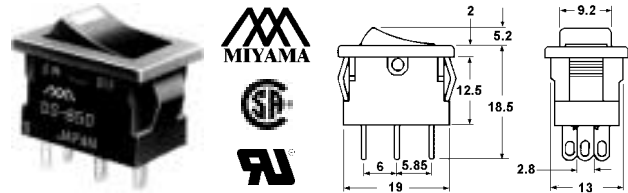

Snap-in mounting 5A @ 125VAC(3A/250V).
LED requires external limit resistor.

- 46-140-0 SPST on-off red LED indicator
- 46-141-0 SPST on-off green LED indicator

Use -1 for Display Package

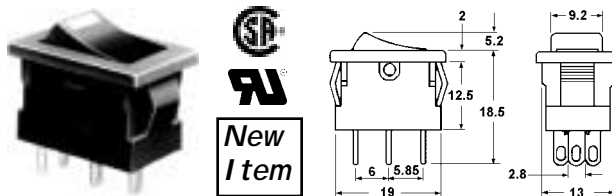

Snap-in mounting 10A @ 125VAC(6A/250V).
LED requires external limit resistor.

- 46-140J-0 SPST on-off red LED indicator
- 46-141J-0 SPST on-off green LED indicator

Use -1 for Display Package

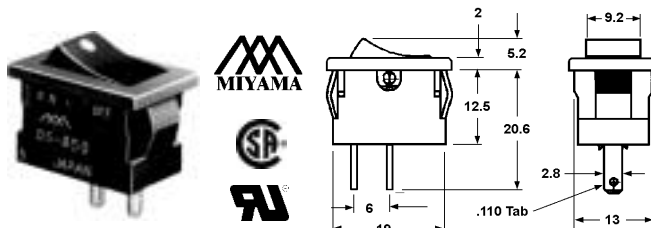

Snap-in mounting 5A @ 125VAC (3A/250V).
Available with white dot or ON-OFF markings.

- 46-143-0 SPST on-off black button white dot
- 46-144-0 SPST on-off black button ON-OFF

Use -1 for Display Package

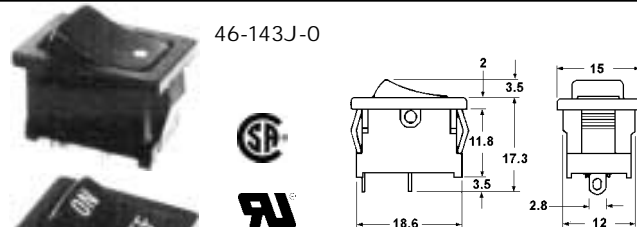

46-143J-0

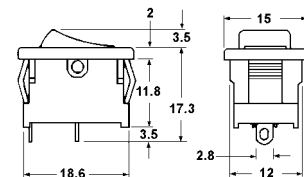

Snap-in mounting

46-144J-0

10A @ 125VAC/ (6A/250V)

- 46-143J-0 SPST on-off black button white dot
- 46-144J-0 SPST on-off black button ON-OFF

Use -1 for Display Package



New Item

WEATHERPROOF CAP

Suitable for 46-14x type switches.

46-149J-0 Waterproof Cap
Use -5 for Display Package

46-145J-0



New Item

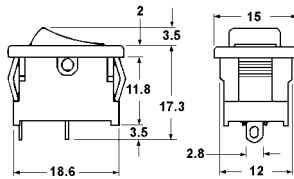

46-146J-0 Snap-in mounting



46-145J 10A @ 125VAC/ (6A/250V)
46-146J 6A @ 125VAC/ (3A/250V)

46-145J-0 SPDT on-off-on black Int. Symbol
46-146J-0 SPST (on)-off black button ON-OFF
Use -1 for Display Package

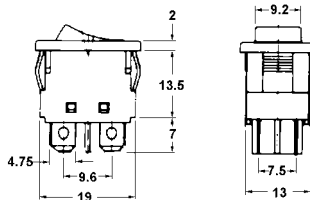

Snap-in mounting 10A @ 250VAC

46-150-0 DPST on-off black button white dot
46-151-0 DPST on-off black button ON-OFF
Use -1 for Display Package

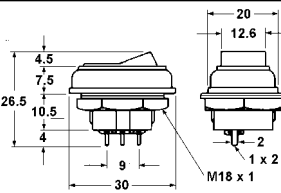

Round 18mm diameter mounting hole 6A @ 125VAC

46-170-0 SPST on-off white button
46-183-0 DPDT on-on white button
Use -1 for Display Package

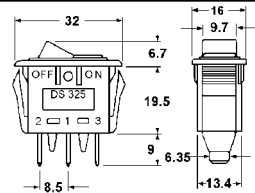

Snap-in mounting with neon indicator. 15A @ 125VAC.
Mtg. hole: 30.2 x 11mm

46-190-0 SPST on-off amber rocker
46-192-0 SPST on-off red rocker
Use -1 for Display Package

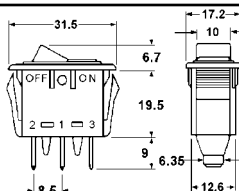

Snap-in mounting with neon indicator. 16A @ 125VAC.
Mtg. hole: 29 x 13mm

46-190J-0 SPST on-off amber rocker
46-192J-0 SPST on-off red rocker
Use -1 for Display Package

KEY SWITCHES

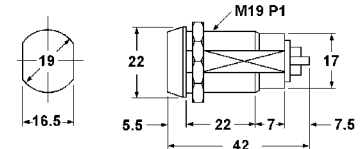

SPST Key removable in either position.
4 A @ 125VAC

47-282-0 Bulk assorted keys
47-282-1 Pkg assorted keys
47-282K-0 Bulk same key
47-282-KEY Blank Key

MICRO SWITCHES

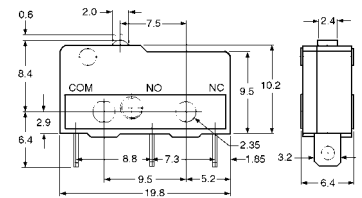

5A @ 125VAC (3A/250V) N/O and N/C contacts.
Life: 200,000 operations (full load)
Contact resistance: 30mΩ maximum
Insulation resistance: 100MΩ min. (500VDC)
Dielectric strength: 1000VAC for 1 minute

47-300-0 Bulk **47-300-1** Package



47-400-0

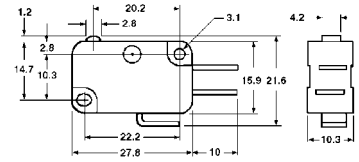

47-402-0

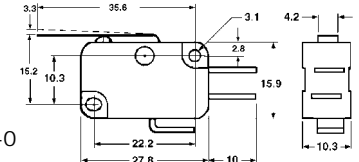

47-406-0

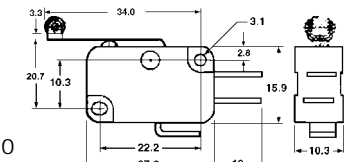

47-403-0

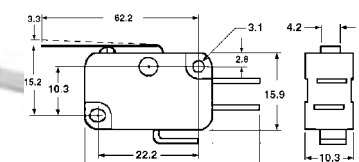

15A @ 125VAC or 250VAC

Contact resistance: 15mΩ maximum (initial)
Insulation resistance: 100MΩ min (@ 500VDC)
Dielectric strength: 1,000VAC for 1 minute
Service life mechanical: 1,000,000 operations
Service life electrical: 100,000 operations (full load)

All have .187" faston terminals and N/O and N/C terminals.

47-400-0 No actuator
47-402-0 27.5mm actuator
47-403-0 54.1mm actuator
47-406-0 25.9mm roller actuator
Use -1 for Display Package

CIRCUIT BREAKERS



125VAC
50VDC

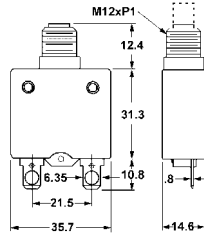

- | | | | |
|----------|-----|----------|-----|
| 47-503-0 | 3A | 47-515-0 | 15A |
| 47-504-0 | 4A | 47-520-0 | 20A |
| 47-505-0 | 5A | 47-525-0 | 25A |
| 47-510-0 | 10A | 47-530-0 | 30A |

Use -1 for Display Package



DPDT & 4PDT 5 AMP RELAYS

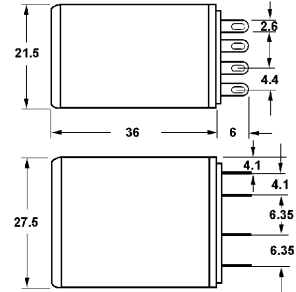

- | | |
|------------------------|--------------------|
| Contact Resistance: | 50mΩ max. |
| Operate Time: | 25ms max. |
| Release Time: | 25ms max. |
| Insulation Resistance: | 100MΩ min. |
| Mechanical Life: | 10M cycles |
| Electrical Life: | 100K cycles |
| Resistive Load: | 5A@28VDC or 250VAC |

New Item

MAGNETIC SWITCHES



Magnetic reed switch for security alarms. Has normally open and normally closed switch contacts. Screw terminals.
12VDC@500ma

- | | |
|----------|------|
| 47-600-0 | Bulk |
| 47-600-1 | Pkg. |

ROTARY SWITCHES

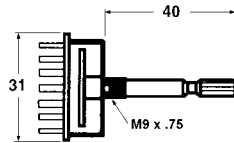

.3 A @ 30VDC non-shorting. Knurled shaft with split.

- | | | |
|----------|--------|-------------|
| 48-511-0 | 1 pole | 12 position |
| 48-512-0 | 2 pole | 6 position |
| 48-513-0 | 3 pole | 4 position |
| 48-514-0 | 4 pole | 3 position |

Use -1 for Display Package

RELAYS

AUTOMOTIVE RELAYS

New Item

12 VDC

- | | |
|-----------|-------------|
| 50-836-0 | SPDT 30 AMP |
| 50-836H-0 | SPDT 40 AMP |



10 AMP OCTAL BASE RELAYS



New Item

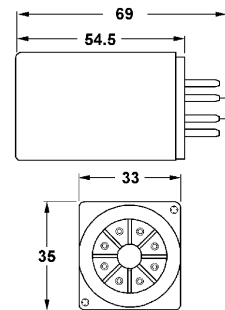

- | | |
|------------------------|---------------------|
| Contact Resistance: | 50mΩ max. |
| Operate Time: | 20ms max. |
| Release Time: | 20ms max. |
| Insulation Resistance: | 100MΩ min. |
| Mechanical Life: | 10M cycles |
| Electrical Life: | 100K cycles |
| Resistive Load: | 10A@28VDC or 120VAC |



Socket Housing for Auto Relays

New Item

c/w 6 terminals

50-920-0 Auto Relay Socket

Part Number	Circuitry	Oper. Volt.	Coil Res.
50-133-0	SPDT	12VDC	120 Ω
50-134-0	SPDT	24VDC	472 Ω
50-139-0	SPDT	120VAC	2250 Ω
50-163-0	DPDT	12VDC	120 Ω
50-164-0	DPDT	24VDC	472 Ω
50-169-0	DPDT	120VAC	2250 Ω

We have many more styles of relays available. Contact us or your local Mode Distributor for additional information.



Octal Base Socket for 50-13x & 50-16x series on previous page.

New Item

50-910-0 Octal Socket



Socket for 50-06x and 50-09x shown on previous page.

New Item

50-901-0 DPDT PC Mount
 50-902-0 4PDT PC Mount
 50-911-0 DPDT Screw Term.
 50-912-0 4PDT Screw Term.

3 AMP PC RELAYS



New Item

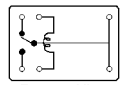
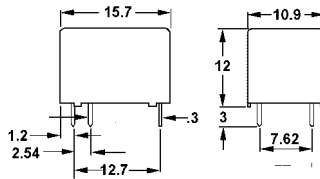

Bottom View

Contact Resistance: 100mΩ max.
 Operate Time: 10ms max.
 Release Time: 5ms max.
 Insulation Resistance: 100MΩ min.
 Mechanical Life: 10M cycles
 Electrical Life: 500K cycles
 Resistive Load: 3A@28VDC or 120VAC

Part Number	Circuitry	Oper. Volt.	Coil Res.
50-330-0	SPDT	5VDC	120 Ω
50-331-0	SPDT	6VDC	180 Ω
50-333-0	SPDT	12VDC	700 Ω
50-334-0	SPDT	24VDC	2800 Ω

1 AMP PC RELAYS (16-PIN DIP)



New Item

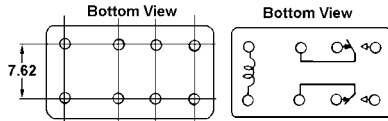
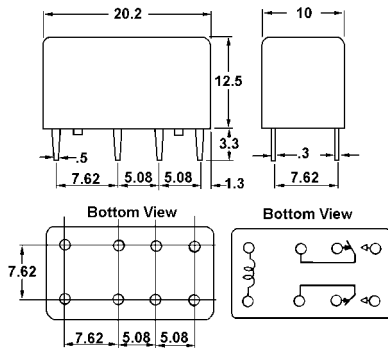

Contact Resistance: 50mΩ max.
 Operate Time: 10ms max.
 Release Time: 4ms max.
 Insulation Resistance: 100MΩ min.
 Mechanical Life: 100M cycles
 Electrical Life: 100K cycles
 Resistive Load: 1A@30VDC or .3A@125VAC

Part Number	Circuitry	Oper. Volt.	Coil Res.
50-430-0	2C	5VDC	125 Ω
50-433-0	2C	12VDC	720 Ω
50-434-0	2C	24VDC	2880 Ω
50-435-0	2C	48VDC	4600 Ω

10 AMP PC RELAYS

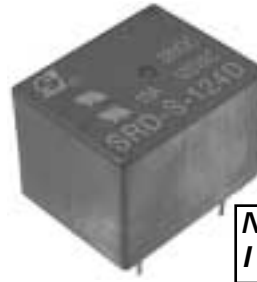

New Item

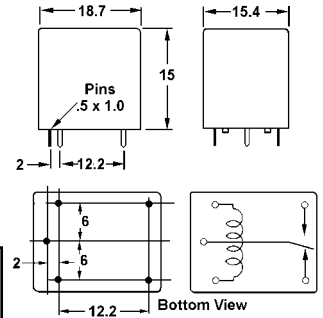

Contact Resistance: 100mΩ max.
 Operate Time: 8ms max.
 Release Time: 5ms max.
 Insulation Resistance: 100MΩ min.
 Mechanical Life: 10M cycles
 Electrical Life: 100K cycles
 Resistive Load: 10A@28VDC or 10A@125VAC
 Inductive Load: 3A@28VDC or 3A@125VAC



Part Number	Circuitry	Oper. Volt.	Coil Res.
50-530-0	SPDT	5VDC	70 Ω
50-533-0	SPDT	12VDC	400 Ω
50-534-0	SPDT	24VDC	1600 Ω
50-535-0	SPDT	48VDC	6400 Ω

PLASTIC CASES



Black plastic project boxes.

Outside dimensions shown

53-520-0 82L x 54W x 31H (plastic cover)
 53-522-0 83L x 54W x 30H (alum. cover)
 53-540-0 103L x 54W x 40H (alum. cover)

Use -1 for Display Package



Inside dimensions shown

53-541-0 99L x 49W x 40H grey ABS plastic
 53-551-0 125L x 60W x 40H grey ABS plastic
 53-571-0 145L x 85W x 50H grey ABS plastic
 53-581-0 180L x 110W x 60H grey ABS plastic

Use -1 for Display Package



53-918-0 275Lx182Wx40H polypropylene box with 18 compartments.

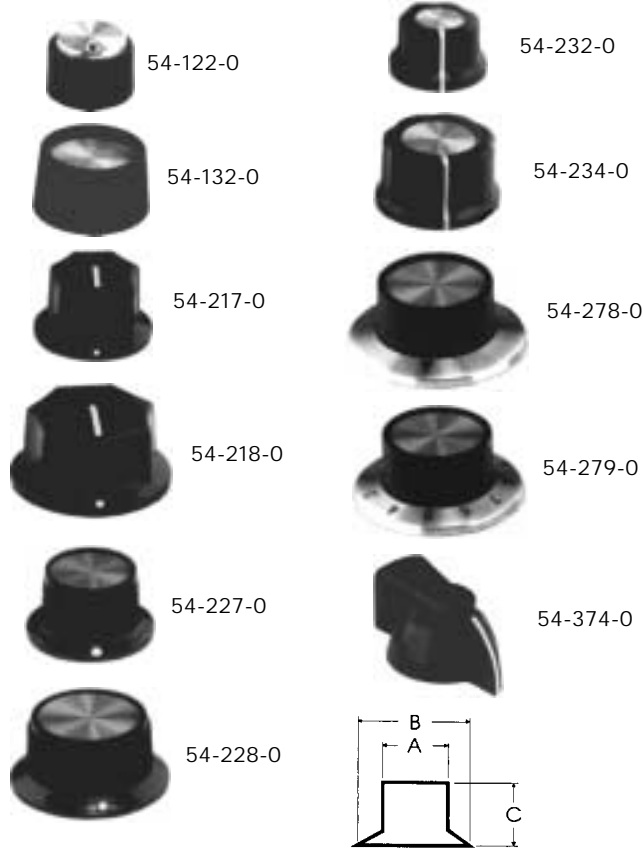

Part Number	A	B	C	Shaft
54-122-0	15mm	15mm	12mm	6.35mm
54-132-0	20mm	22mm	13mm	6.35mm
54-217-0	18mm	23mm	15mm	6.35mm
54-218-0	27mm	33mm	17mm	6.35mm
54-227-0	19mm	25mm	15mm	6.35mm
54-228-0	26mm	32mm	15mm	6.35mm
54-232-0	16mm	20mm	12mm	6.35mm
54-234-0	24mm	27mm	16mm	6.35mm
54-278-0	23mm	37mm	15mm	6.35mm
54-279-0	23mm	37mm	15mm	6.35mm
54-374-0	30mm	Pointer Knob		6.35mm

Use -2 for Display Package 6.35mm = 1/4"

We have many more styles of knobs available. Contact us or your local Mode Distributor for additional information.

METRIC HARDWARE

Nickel plated round phillips head screws



Size				Length
2mm	2.6mm	3mm	4mm	
54-400-0	54-410-0	54-420-0	54-430-0	6mm
54-401-0	54-411-0	54-421-0	54-431-0	8mm
54-402-0	54-412-0	54-422-0	54-432-0	10mm
54-403-0	54-413-0	54-423-0	54-433-0	12mm
54-404-0	54-414-0	54-424-0	54-434-0	14mm
54-405-0	54-415-0	54-425-0	54-435-0	16mm

Nickel plated nuts



Size			
2mm	2.6mm	3mm	4mm
54-406-0	54-416-0	54-426-0	54-436-0

Nickel plated flat washers



Size			
2mm	2.6mm	3mm	4mm
54-407-0	54-417-0	54-427-0	54-437-0

Nickel plated split and internal star lockwashers



Size				Type
2mm	2.6mm	3mm	4mm	
54-408-0	54-418-0	54-428-0	54-438-0	Int. Star
54-409-0	54-419-0	54-429-0	54-439-0	Split

METRIC HARDWARE KITS



54-444-1

54-440-1 2mm Hardware Kit

Contains: 180 pieces of assorted 2mm screws, nuts, flat washers and lockwashers. Screws provided are 6, 8, 10 and 12mm lengths. In a clear polystyrene compartmented box. (not shown).

54-441-1 2.6mm Hardware Kit

Contains: 180 pieces of assorted 2.6mm screws, nuts, flat washers and lockwashers. Screws provided are 6, 8, 10 and 12mm lengths. In a clear polystyrene compartmented box. (not shown).

54-442-1 3mm Hardware Kit

Contains: 180 pieces of assorted 3mm screws, nuts, flat washers and lockwashers. Screws provided are 6, 8, 10 and 12mm lengths. In a clear polystyrene compartmented box. (not shown).

54-443-1 4mm Hardware Kit

Contains: 140 pieces of assorted 4mm screws, nuts, flat washers and lockwashers. Screws provided are 6, 8, 10 and 12mm lengths. In a clear polystyrene compartmented box. (not shown).

54-444-1. Comprehensive hardware assortment.

Contains: 1200 assorted pieces of 2, 2.6 and 3mm hardware in a durable 18 compartment polypropylene box (53-918-0).

ENGLISH/METRIC CONVERSIONS

LENGTH			
Inch	X	25.40	= Millimeters
Millimeters	X	0.03937	= Inches
Feet	X	0.3048	= Meters
Meters	X	3.281	= Feet
Miles	X	1.609	= Kilometers
Kilometers	X	0.6214	= Miles

UNC HARDWARE

Nickel plated round phillips head screws.



Size					Lgth
2-56	4-40	6-32	8-32	10-32	
54-510-0	54-520-0	54-530-0	54-540-0		1/4"
		54-531-0	54-541-0		3/8"
54-512-0	54-522-0	54-532-0	54-542-0	54-552-0	1/2"
		54-533-0			5/8"
	54-524-0	54-534-0	54-544-0	54-554-0	3/4"

Nickel plated nuts



Size				
2-56	4-40	6-32	8-32	10-32
54-516-0	54-526-0	54-536-0	54-546-0	54-556-0

Nickel plated flat washers



Size				
#2	#4	#6	#8	#10
54-517-0	54-527-0	54-537-0	54-547-0	54-557-0

Nickel plated internal star and split washers



#2	#4	#6	#8	#10	
54-518-0	54-528-0	54-538-0	54-548-0	54-558-0	Int. star
54-519-0	54-529-0	54-539-0	54-549-0	54-559-0	Split

UNC HARDWARE KITS

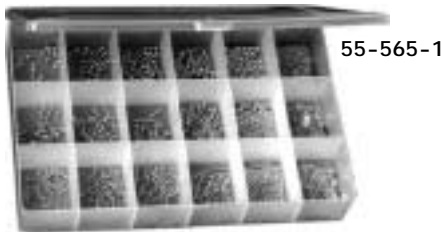

54-561-1 2-56 Hardware assortment
 Contains: 260 pieces of assorted 2-56 screws, nuts, flat washers and lock washers. Screw lengths provided are 1/4" and 1/2". In clear polystyrene box with 6 separate compartments. (not shown).

54-562-1 4-40 Hardware assortment
 Contains: 220 pieces of assorted 4-40 screws, nuts, flat washers and lock washers. Screw lengths provided are 1/4", 1/2" and 3/4". In clear polystyrene box with 6 separate compartments. (not shown).

54-563-1 6-32 Hardware assortment
 Contains: 220 pieces of assorted 6-32 screws, nuts, flat washers and lock washers. Screw lengths provided are 1/4", 3/8", 1/2", 5/8" and 3/4". In a clear polystyrene box with 6 separate compartments. (not shown).

54-564-1 8-32 Hardware assortment
 Contains: 220 pieces of assorted 8-32 screws, nuts, flat washers and lock washers. Screw lengths provided are 1/4", 3/8", 1/2" and 3/4". In a clear polystyrene box with 6 separate compartments. (not shown).

54-565-1 Comprehensive hardware assortment.
 Contains: 1175 pieces of assorted 2-56, 4-40, 6-32, and 8-32 hardware. In a durable 18 compartment polypropylene box (53-918-0).



All hardware is available in bulk and attractive clear plastic re-useable display packages. The display packages contain 100 pieces and are designated with -100 after the part number. For example 54-400-100 specifies a display package of 100.

RUBBER GROMMETS

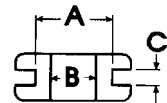

Bulk #	A	B	C
54-811-0	5/16"	3/16"	1/16"
54-814-0	3/8"	1/4"	1/16"
54-817-0	1/2"	3/8"	1/16"

Use -10 for Display Package

RUBBER FEET



54-865-0



54-870-0



54-875-0

Bulk #	Pkg.	A	B	C
54-865-0	-8	7mm	19mm	15mm
54-870-0	-8	12mm	20mm	16mm
54-875-0	-4	16mm	25mm	21mm

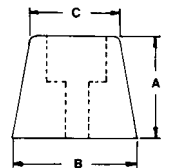

Mounting hardware included.

ADHESIVE RUBBER FEET



54-880-0

54-885-0



54-880-0	Bulk	1/2" round .232" thick
54-880-24	Display Package (24)	
54-885-0	Bulk	1/2" square .232" thick
54-885-24	Display Package (24)	

Visit our Web Site at
<http://www.mode-elec.com>



55-047-0 12V/60mA lead wire lamp
55-056-0 12V/140mA lead wire lamp
Use -2 for Display Package



T 1-3/4(5mm) screw base bulb
55-086-0 12V/100mA
Use -4 for Display Package



55-120-0 Bulk NE-2 Neon bulb
55-120-2 Display Package

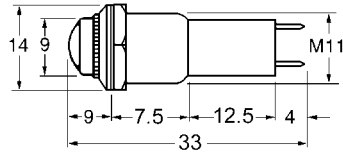

T 1-3/4 (5mm) screw base

55-302-0 Red Bulk
55-305-0 Green Bulk
Use -1 for Display Package

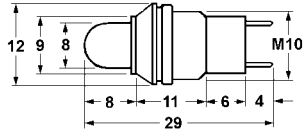

T 1-3/4 (5mm) screw base

55-312-0 Red Bulk
55-315-0 Green Bulk
Use -1 for Display Package

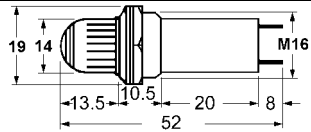

T 3-1/4 (10mm) bayonet base

55-322-0 Red Bulk
55-325-0 Green Bulk
Use -1 for Display Package

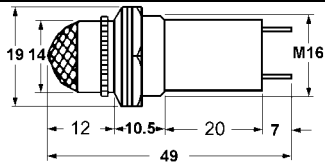

T 3-1/4 (10mm) bayonet base

55-342-0 Red Bulk
55-343-0 Amber Bulk
55-345-0 Green Bulk
Use -1 for Display Package

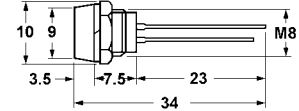

Black plastic bezel LED indicator

These indicators require a resistor to limit current. See note below for details.

55-430-0 Red LED Bulk
55-431-0 Green LED Bulk
Use -1 for Display Package

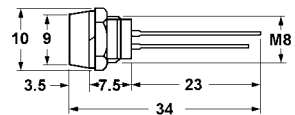

Chrome plated LED indicator

These indicators require a resistor to limit current. See note below for details.

55-432-0 Red LED Bulk
55-433-0 Green LED Bulk
Use -1 for Display Package

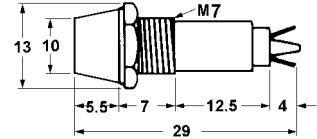

Neon indicators (internal resistor) 120VAC

55-442-0 Red neon 120VAC
55-443-0 Amber neon 120VAC
55-445-0 Green neon 120VAC
Use -1 for Display Package

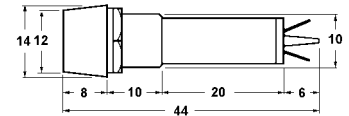

Neon indicators (internal resistor) 120VAC

55-462-0 Red neon 120VAC
55-463-0 Amber neon 120VAC
55-465-0 Green neon 120VAC
Use -1 for Display Package

All LED's (including the LED indicator lamps above) require a resistor in series to limit the current to the required specification (usually 20mA). Use Ohm's law to calculate the value of the resistor required. Most LED's have a voltage drop of 2 volts. Blue & white LED's are 3.5 - 4 volts.

$$V=IR \text{ (volts = current(amps) } \times \text{ resistance)}$$

For a 12VDC supply voltage @ 20mA the required resistor would be:

$$10 \text{ (volts)} / .02 \text{ (amps)} = 500 \text{ ohms}$$

LED'S ARE SUITABLE FOR DC ONLY

Visit our Web Site at
<http://www.mode-elec.com>

STANDARD 3mm LED'S

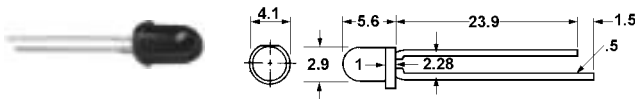

Brightness rating @ 10mA

55-532-0	Red	3.0MCD
55-533-0	Orange	3.5MCD
55-534-0	Yellow	18MCD
55-535-0	Green	18MCD

Use -5 for Display Package

HIGH BRIGHTNESS 3mm LED'S

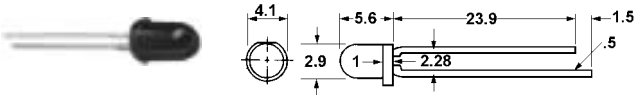

Brightness rating @ 20mA

New Item

55-532HB-0	Red	400-500MCD
55-534HB-0	Yellow	400-600MCD
55-535HB-0	Green	600-1000MCD

New Item

Use -3 for Display Package

SUPER BRIGHT 3mm LED'S

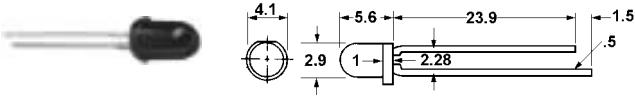

Brightness rating @ 20mA

New Item

55-532SB-0	Red	800-1000MCD
55-534SB-0	Yellow	1000-1200MCD
55-535SB-0	Green	2000-3000MCD
55-536SB-0	White	1000-2000MCD
55-537SB-0	Blue	800-1000MCD

New Item

Use -1 for Display Package

3mm MOUNTING BEZEL



3mm plastic mounting bezel (1 piece)

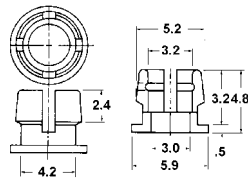

55-530-0	Bulk
55-530-10	Display Package (10)

3mm R/A LED'S



Brightness level @ 10mA

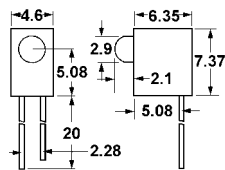

55-542-0	Red	3.2MCD
55-545-0	Green	15MCD

Use -5 for Display Package

5mm LED HOLDER



Plastic 2 piece panel mount holder for 5mm LED's.

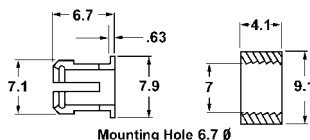

55-550-0	Bulk
55-550-10	Display Package (10)

New Item

5mm LED HOLDER (concave)

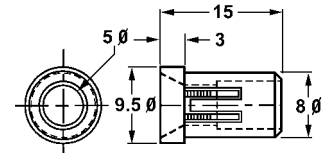

Plastic 1 piece panel mount holder for 5mm LED's.

55-550A-0	Bulk
55-550A-4	Display Package (4)

New Item

5mm LED HOLDER (convex)

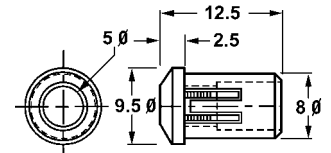

Plastic 1 piece panel mount holder for 5mm LED's.

55-550B-0	Bulk
55-550B-4	Display Package (4)

STANDARD 5mm LED'S

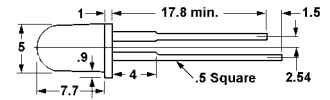

5mm LED's Brightness rating @ 10mA

New Item

*

55-552-0	Red	30MCD
55-553-0	Orange	30MCD
55-554-0	Yellow	30MCD
55-555-0	Green	30MCD
55-558-0*	Blue	60MCD
55-558-1*	package	

Use -5 for Display Package

5mm HIGH BRIGHTNESS LED'S

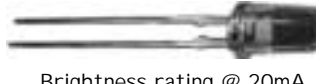

Brightness rating @ 20mA

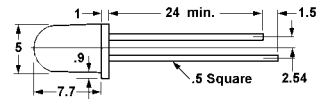

New Item

*

55-556-0	Red	600MCD
55-556-5	Display Package (5)	
55-555HB-0*	Green	900-1500MCD
55-555HB-1*	Display Package (1)	
55-558HB-0*	Blue	900-1000MCD
55-558HB-1*	Display Package (1)	
55-559HB-0*	White	900-1500MCD
55-559HB-1*	Display Package (1)	

5mm SUPER BRIGHT LED'S



Brightness rating @ 20mA

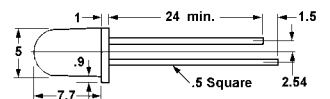

New Item

*

55-557-0	Red	2500MCD
55-557-2	Display Package (2)	
55-554SB-0*	Yellow	2000-2500MCD
55-554SB-2*	Display Package (2)	
55-555SB-0*	Green	3000-6000MCD
55-555SB-1*	Display Package (1)	
55-558SB-0*	Blue	1000-2000MCD
55-558SB-1*	Display Package (1)	
55-559SB-0*	White	2000-3000MCD
55-559SB-1*	Display Package (1)	

5mm R/A LED's

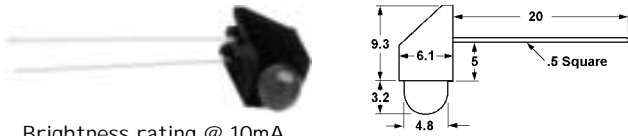

Brightness rating @ 10mA

55-562-0	Red	3.2MCD
55-564-0	Yellow	5.0MCD
55-565-0	Green	5.7MCD

Use -5 for Display Package

5mm FLASHING LED

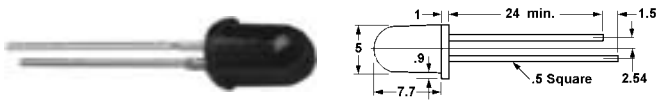

5mm flashing LED. Requires no external circuitry. Easily driven by TTL or C-MOS (3-12VDC)

55-572-0	Red	1.6MCD
55-572-2	Display Package (2)	

BI-COLOR LED'S

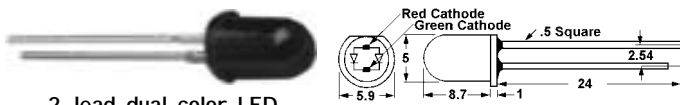

2-lead dual color LED

55-582-0	Red/Green	2.2/3.5MCD
55-582-5	Display Package (5)	

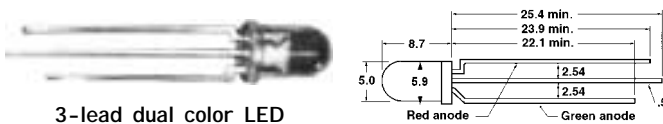

3-lead dual color LED

55-592-0	Red/Green	2.2/2.5MCD
55-592-5	Display Package (5)	

RECTANGULAR LED'S

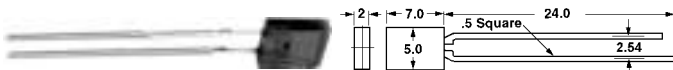

2 x 5mm rectangular LED's

55-602-0	Red	2.2MCD
55-603-0	Orange	4.5MCD
55-604-0	Yellow	3.5MCD
55-605-0	Green	3.7MCD

Use -5 for Display Package

FUSEHOLDERS 10A @ 250VAC



Bayonet style fuse holder for 3AG (1/4" x 1 1/4") fuses.

		55-800-0	Bulk
		55-800-1	Display Package

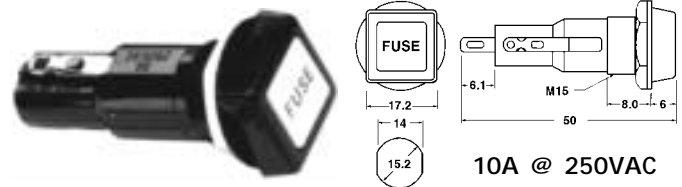

10A @ 250VAC

Pop-out style fuseholder for 3AG (1/4" x 1 1/4") fuses.

	55-801-0	Bulk		
	55-801-1	Display Package		

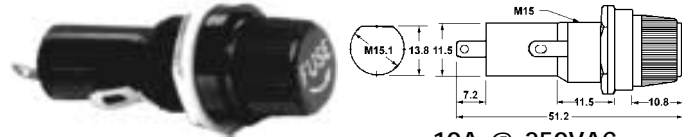

10A @ 250VAC

Screw type fuseholder for 3AG (1/4" x 1 1/4") fuses.

	55-802-0	Bulk	
	55-802-1	Display Package	

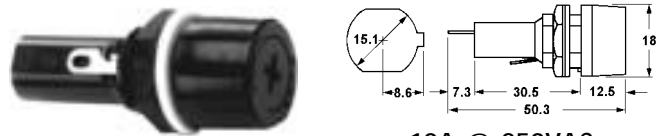

10A @ 250VAC

Screw type fuseholder 3AG (1/4" x 1 1/4") fuses.

	55-804-0	Bulk	
	55-804-1	Display Package	

INLINE FUSEHOLDER

Screw bakelite fuseholder for 3AG (1/4" x 1 1/4") fuses. 45cm of 12 AWG red wire. 20A @ 250VAC



55-820-0	Bulk
55-820-1	Pkg

INLINE FUSEHOLDER

Polypropylene fuseholder for 3AG (1/4" x 1 1/4") fuses. 19cm red 18AWG wire. 5A @ 250VAC.



55-821-0	Bulk
55-821-1	Pkg

FUSES

Standard 3AG size (1/4" x 1 1/4") fuses. Slow blow (MDL) & fast blow (AGC). Available in bulk only.



Slow blow	
55-955-0	.5 Amp
55-970-0	2 Amp

Fast blow			
55-905-0	.5 Amp	55-907-0	.75 Amp
55-910-0	1 Amp	55-915-0	1.5 Amp
55-920-0	2 Amp	55-923-0	3 Amp
55-925-0	5 Amp	55-930-0	10 Amp
55-932-0	15 Amp	55-933-0	20 Amp

Visit our Web Site at
<http://www.mode-elec.com>

BATTERY HOLDERS



4 x 'C'
57-242-0 Bulk
57-242-1 Package

New Item



2 x 'AA'
57-322-0 Bulk
57-322-2 Package



4 x 'AA'
57-342-0 Bulk
57-342-2 Package



4 x 'AA'
57-343-0 Bulk
57-343-2 Package



2 x 'AAA'
57-422-0 Bulk
57-422-2 Package



4 x 'AAA'
57-442-0 Bulk
57-442-2 Package

BATTERY SNAPS



57-901-0



57-902-0

9 Volt battery snaps -
24AWG 150mm long

57-901-0 'I' type Bulk
57-902-0 'T' type Bulk
Use -10 for Display Package



9 Volt *molded* battery snaps -
24AWG 150mm long

New Item

57-902M-0 'T' type Bulk

Use -5 for Display Package

SPEAKER TERMINALS



4 push type terminals, color coded for any audio application. Overall size: 75mm x 20mm. Mounting holes 64mm centre to centre.

58-094-0 Bulk
58-094-1 Package



Phenolic mounted push-type speaker terminals. 23 W x 50 L 39.5 mm mtg. holes.

58-098-0 Bulk
58-098-2 Package



Push type speaker terminals 20 W x 55 L 45mm mtg. holes

58-099-0 Bulk
58-099-2 Package

TERMINAL BLOCKS

SPECIFICATIONS

Materials:
Housing: Polyamid 6.6
Terminals: Tin plated brass
Contacts: Nickel plated brass

Electrical:
Ratings: 8A @ 300 Volts
Wire size: 14 AWG maximum

These lock together forming a continuous 5mm spacing terminal block

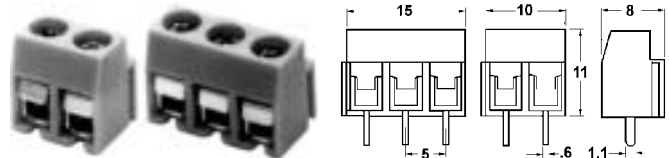

58-102-0 Bulk 2-position
58-102-3 Package (3)
58-103-0 Bulk 3-position
58-103-2 Package (2)



SPECIFICATIONS

Materials:
Housing: Polyamid 6.6
Terminals: Tin plated brass
Contacts: Nickel plated brass

Electrical:
Ratings: 10 Amp @ 300 Volts
Wire size: 14 AWG maximum

These lock together forming a continuous 5mm spacing terminal block

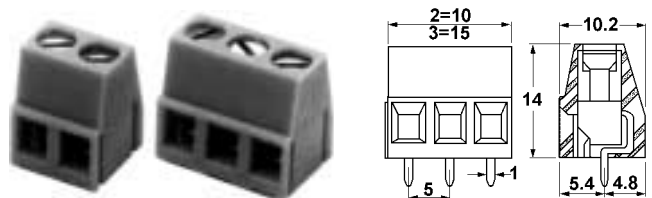

58-112-0 Bulk 2-position
58-112-3 Package (3)
58-113-0 Bulk 3-position
58-113-2 Package (2)



TERMINAL BLOCKS

These 12 position flexible terminal blocks can be cut to length.



3 Amp
58-301-0
58-301-2

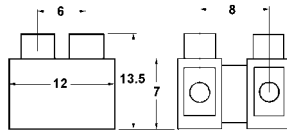

Bulk
Package



6 Amp
58-302-0
58-302-2

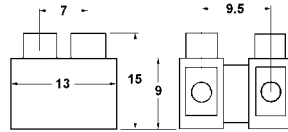

Bulk
Package

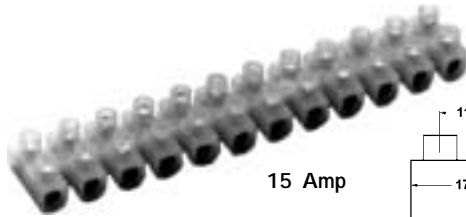

15 Amp
58-303-0
58-303-1

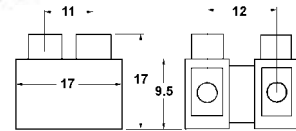

Bulk
Package

These flexible 12-position terminal blocks with wire protectors are made of Nylon 66, UL94V2 and are approved by most agencies including CSA, UL, VDE, OVE.



Current: UL
CSA
Wire: UL
CSA
58-308-0
58-308-1

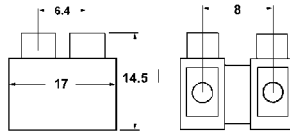

20 Amps/600V
10 Amps/400V
12-22 AWG
18-20AWG



Bulk
Pkg



Current: UL
CSA
Wire: UL
CSA
58-312-0
58-312-1

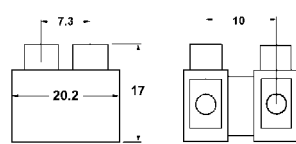

30 Amps/600V
20 Amps/400V
10-22 AWG
14-18AWG



Bulk
Pkg

FANS

These fans are offered with a **3 year warranty** covering defects in materials and workmanship. We stock only sleeve bearing types on the manufacturers recommendation. These sleeve bearing fans have confirmed life expectancies of up to 50,000 hours even at high ambient temperatures. Ball bearing fans have a slightly longer life but their noise levels begin to increase in a very short time. A sleeve bearing fan does not suffer from this problem. The DC fans have an innovative (patented) motor construction that features a single coil. This design increases reliability and the smaller diameter of the motor allows increased air flow. Please note that voltages shown have a tolerance of +/- 15%. Exceeding this tolerance will damage the motor.

59-100-0 115VAC 120 x 120 x 38mm

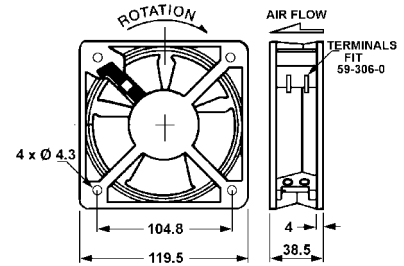

3 YEAR WARRANTY



Bearing: Sleeve type
Load: .18 Amps (18 watts)
Speed: 2900 RPM
Air flow: 105 CFM
Noise: 48 dbA

59-224-0 12VDC 25 x 25 x 10mm



3 YEAR WARRANTY



Bearing: Sleeve type
Load: .095 A (1.1 watts)
Speed: 10,000 RPM
Air flow: 1.7 CFM
Noise: 26.5 dbA

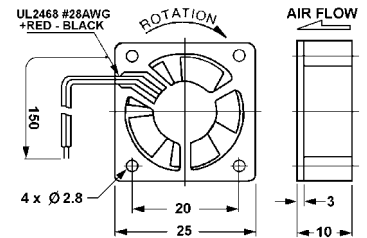

59-244-0 12VDC 40 x 40 x 20mm



3 YEAR WARRANTY



Bearing: Sleeve type
Load: .05 A (.6 watts)
Speed: 4500 RPM
Air flow: 5.2 CFM
Noise: 22.8 dbA

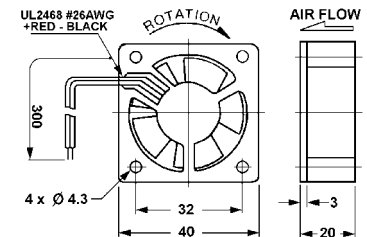

MORE FANS ON NEXT PAGE

The fans shown in this catalog are our most popular types. If you require a different size or voltage, please contact us or your local Mode distributor for price and availability.

Mode Electronics is proud to be ISO 9003 Certified.



59-264-0 12VDC 60 x 60 x 25mm

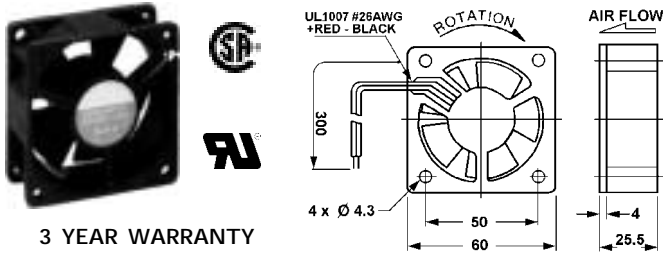

3 YEAR WARRANTY

Bearing: Sleeve type
 Load: .16 A (1.9 watts)
 Speed: 3800 RPM
 Air flow: 17.6 CFM
 Noise: 31 dbA

59-284-0 12VDC 80 x 80 x 25mm

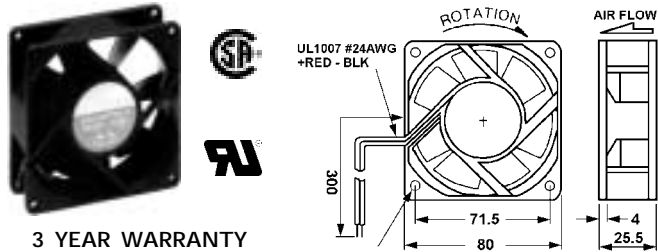

3 YEAR WARRANTY

Bearing: Sleeve type
 Load: .12 A (1.4 watts)
 Speed: 2200 RPM
 Air flow: 26.5 CFM
 Noise: 24.5 dbA

59-294-0 12VDC 92 x 92 x 25mm

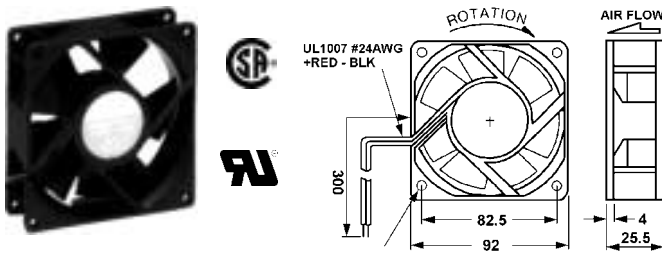

3 YEAR WARRANTY

Bearing: Sleeve type
 Load: .16 A (2.0 watts)
 Speed: 2700 RPM
 Air flow: 44 CFM
 Noise: 27 dbA

FAN ACCESSORIES

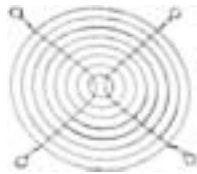

Nickel plated finger guards
 59-310-0 120mm
 59-314-0 40mm
 59-316-0 60mm
 59-318-0 80mm
 59-319-0 92mm



600mm power cord for 59-100-0.
 59-306-0 Bulk

AUDIO TRANSFORMERS

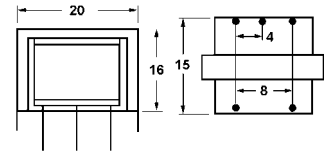

Primary: 500Ω center-tapped
60-281-0 Secondary: 8Ω Bulk

Primary: 1.2KΩ center-tapped
60-282-0 Secondary: 8Ω Bulk

Use -1 for Display Package

600Ω : 600Ω TRANSFORMER

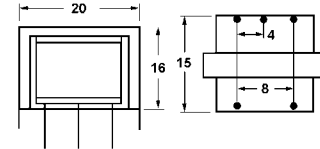

Primary: 600Ω
 Secondary: 600Ω
 Freq. response: 300Hz - 3500Hz
 Max. current: 160mA
60-606-0 Bulk
60-606-1 Display Package
 Center pin on primary side is an electrostatic shield.

POWER TRANSFORMER

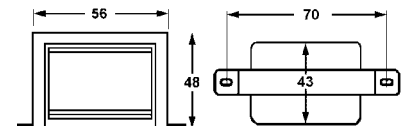

Input Voltage: 120VAC 60Hz
 Output: 12.6VAC @ 1A
 Centre tap: 6.3VAC @ .5A
60-912-0 Bulk

AUDIO L PADS



8 ohm 15 watt balanced impedance audio level control.

61-111-0 Mono Bulk
61-112-0 Stereo Bulk

Use -1 for Display Package

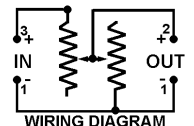

Visit our Web Site at
<http://www.mode-elec.com>

Mode Electronics is proud to be ISO 9003 Certified.



POTENTIOMETERS *Cont'd*

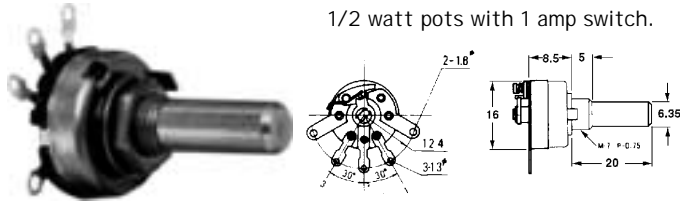

1/2 watt pots with 1 amp switch.

62-222-0	1K	linear
62-223-0	5K	linear
62-224-0	10K	linear
62-254-0	10k	log (audio)
62-226-0	50K	linear
62-227-0	100K	linear
62-228-0	500K	linear
62-229-0	1M	linear

Use -1 for Display Package

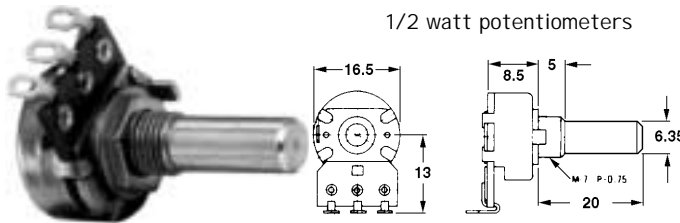

1/2 watt potentiometers

62-243-0	5K	linear
62-234-0	10K	log (audio)
62-244-0	10K	linear
62-236-0	50K	log (audio)
62-246-0	50K	linear
62-247-0	100K	linear
62-248-0	500K	linear

Use -1 for Display Package

AC ADAPTERS

CSA/UL wall mount adapters with 2.1mm output plug.
Most available in *centre negative* or *centre positive*.



68-650-1	6VDC @ 500mA	centre negative
68-650P-1	6VDC @ 500mA	centre positive
68-901-1*	9VDC @ 1 Amp	centre negative
68-901A-1*	9VAC @ 1 Amp	AC Output
68-950-1	9VDC @ 500mA	centre negative
68-950P-1	9VDC @ 500mA	centre positive
68-121-1	12VDC @ 1A	centre negative
68-121P-1	12VDC @ 1A	centre positive
68-121A-1*	12VAC @ 1A	AC Output
68-125-1	12VDC @ 500mA	centre negative
68-125P-1	12VDC @ 500mA	centre positive
68-128-1	12VDC @ 800mA	centre negative
68-128P-1	12VDC @ 800mA	centre positive
68-163A-1*	16VAC @ 300mA	AC Output
68-242-1	24VDC @ 200mA	centre negative
68-242P-1	24VDC @ 200mA	centre positive
68-244-1*	24VDC @ 350mA	centre negative
68-246-1*	24VDC @ 600mA	centre negative

AC ADAPTERS

UNIVERSAL ADAPTER



These multi-voltage adapters feature polarity reversing switch and universal output plugs to fit any application.

68-514-1	3, 4.5, 6, 7.5, 9, 12VDC @ 500mA
68-518-1	3, 4.5, 6, 7.5, 9, 12VDC @ 800mA

New 68-518-1 *

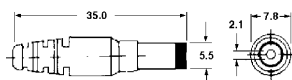

2.1mm plug

ADAPTER DIMENSIONS

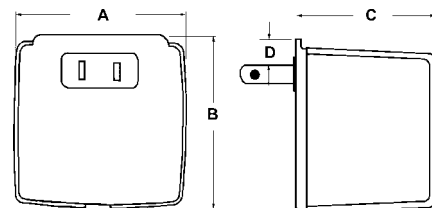

Part #	A	B	C	D
68-650	1.673	2.165	1.476	.354
68-901	2.362	2.362	1.909	.354
68-950	2.075	2.303	1.594	.354
68-121	2.24	3.20	1.90	.500
68-125	2.075	2.303	1.594	.354
68-128	2.362	2.362	1.907	.354
68-163	2.075	2.303	1.594	.354
68-242	2.075	2.303	1.594	.354
68-244	2.342	2.316	1.878	.338
68-246	2.24	3.20	1.90	.500

NOTE: These AC Adapters are unregulated. All voltage ratings shown are at rated load. For instance a 12volt /500mA unit has an output of 12volts at 500mA. If the load is less than 500mA the output voltage will be higher. Output graphs are available if required.

NOTE: There are many more adapters available on special order. If our standard stock units are not suitable please check for availability and minimum order quantities. We would be pleased to quote on your requirements.